

# COMFORT SUITES

5213 PHYSICIAN'S WAY, KYLE, TX 78640

## SWIMMING POOL SHOP DRAWINGS



JOB SITE LOCATION

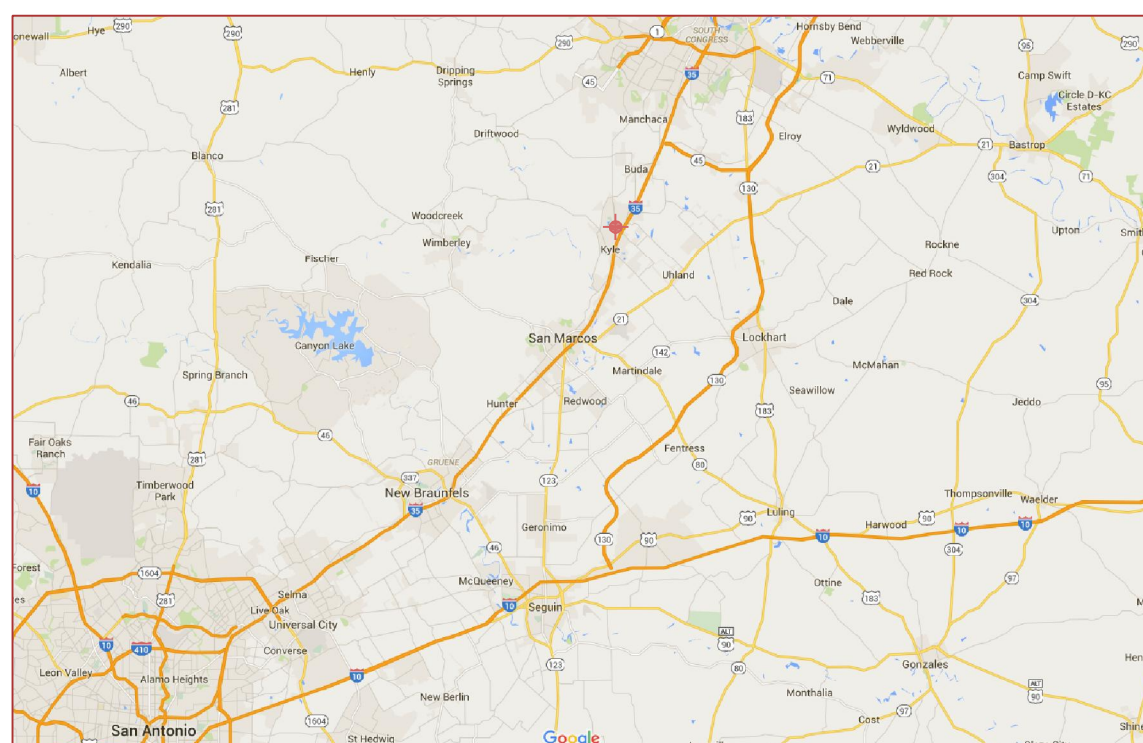
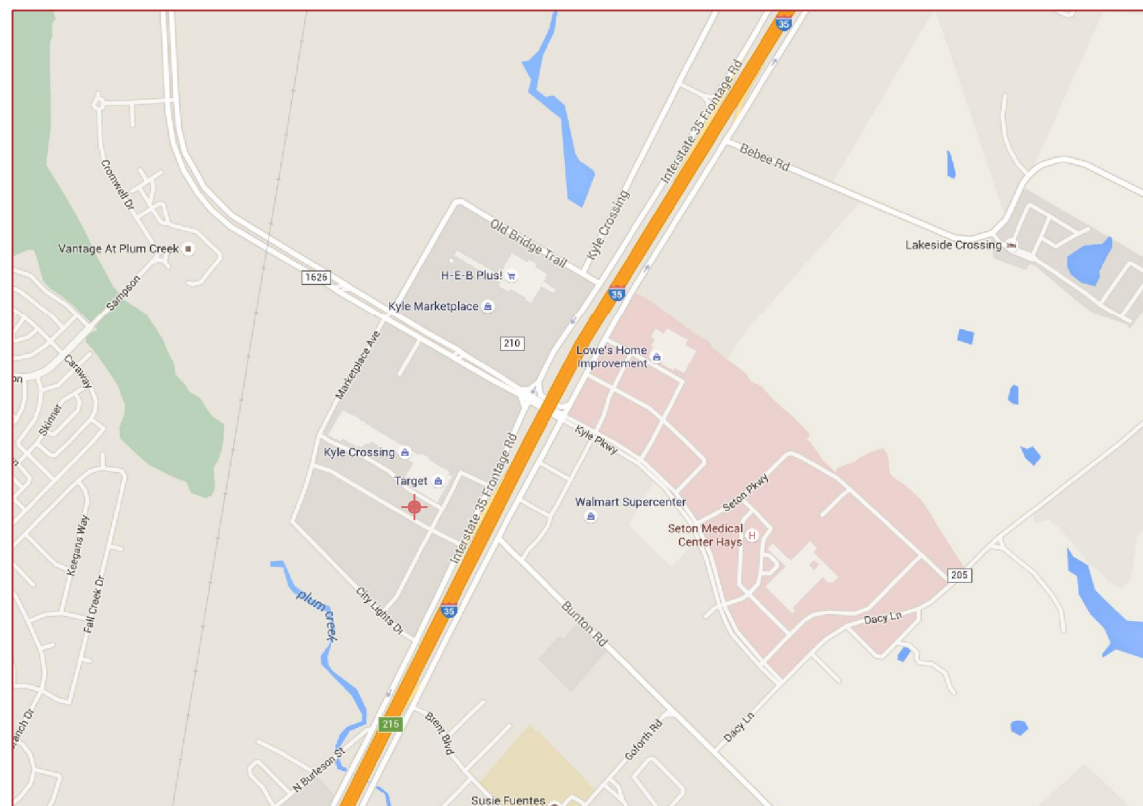

**LEGEND**

**LINE TYPES:**

- ELECTRICAL - BOND WIRE
- ELECTRICAL CONDUIT
- POOL WALL (SHOTCRETE)
- STEEL REINFORCEMENT (REBAR)
- POOL SUCTION LINES
- POOL RETURN LINES
- WATER LINE

**SYMBOLS:**

- SKIMMER
- RETURN FITTING
- WALL LIGHT
- ANTI-ENTRAPMENT MAIN DRAIN
- AUTOFILL
- HANDRAIL
- 2'x2" STEP / BENCH TILE
- 6"x6" DEPTH AND "NO DIVING" MARKERS
- SECTION LINE AND ARROW
- MATERIAL LABEL

FOR QUESTIONS ABOUT THESE DRAWINGS CONTACT



**JAMES C. REYNA**  
Aquatic Design Specialist

**REYNA DESIGN, LLC**  
O: 512.687.7869 C: 512.786.7814  
www.REYNADESIGN.us

**REYNA DESIGN, LLC**  
O: 512.687.7869 C: 512.786.7814  
www.REYNADESIGN.us

EMERALD POOLS AND SPAS  
1139 River Park  
SAN ANTONIO, TX  
PHONE: 210.514.8269

JCR  
COVER, LEGEND, MAP  
**COMFORT SUITES**  
SWIMMING POOL SHOP DRAWINGS  
5213 PHYSICIAN'S WAY, KYLE, TX 78640

PERMIT SET 05.11.2016

COVER, LEGEND, MAP  
SCALE: SHEET:  
N/A COVER

THIS DRAWING, ALL INFORMATION CONTAINED WITHIN, AND ALL SUBMITTED INFORMATION RELATING TO THIS DRAWING, IS THE PROPERTY OF REYNA DESIGN. POSSESSION, USE, OR DUPLICATION BY ANYONE OTHER THAN THE INTENDED RECIPIENT(S), OR WITHOUT EXPLICIT AUTHORIZATION IS PROHIBITED BY LAW AND SUBJECT TO PROSECUTION.



NOTES	SHEETS	POOL SPECIFICATIONS																																																																																																								
<p><b>GENERAL NOTES:</b></p> <p>ALL DRAWINGS PRODUCED BY REYNA DESIGN ARE 'SHOP DRAWINGS' AND ARE INTENDED FOR CLARIFICATION USAGE ONLY</p> <p>ALL DIMENSIONS SHOWN ARE TO BE FIELD VERIFIED AND ARE SUBJECT TO CHANGE</p> <p>ALL POOL PLUMBING TO BE SCHEDULE 40 PVC UNLESS OTHERWISE SPECIFIED</p> <p><b>STRUCTURAL NOTES:</b></p> <p>SHOTCRETE/GUNITITE SHALL MAINTAIN A MINIMUM COMPRESSIVE STRENGTH OF 4,500 PSI @ 28 DAYS.</p> <p><b>REINFORCING STEEL TO BE:</b></p> <p>#4 GRADE 60 PLACED @ 8" O.C.E.W. IN POOLS, UNLESS NOTED OTHERWISE.</p> <p>GOVERNED BY THE LATEST EDITIONS OF THE FOLLOWING CODES OR SPECIFICATIONS; ASTM A615/A615M, NEW, DEFORMED BILLET STEEL BARS, GRADE 60.</p> <p>TIED WITH FS QQ-W-461, BLACK ANNEALED STEEL, 16 GA. (MIN).</p> <p>SPLICED IN ACCORDANCE WITH ACI 315, AND SPLICES SHALL BE 40x DIA. OF BAR SIZE (MIN).</p> <p><b>ELECTRICAL NOTES: (ALL ELECTRICAL WORK BY OTHERS)</b></p> <p>ALL WORK IN POOL AREA SHALL BE IN ACCORDANCE WITH CURRENT NEC, ARTICLES 250 &amp; 680</p> <p>A CLEARLY LABELED EMERGENCY SHUTOFF SWITCH SHALL BE INSTALLED TO DISCONNECT ALL UNGROUNDED CONDUCTORS FOR POOL EQUIPMENT AND UNDERWATER LIGHTING SYSTEMS, AS DEFINED IN THE NATIONAL ELECTRICAL CODE. THE SWITCH SHALL BE INSTALLED IN A PLACE THAT IS READILY ACCESSIBLE WITHIN SIGHT, AND NOT LESS THAN 5 FEET FROM THE WATER'S EDGE. THE SIGN FOR THE SHUT-OFF SWITCH SHALL BE RED IN COLOR, WITH LETTERS CAPABLE OF BEING READ FROM A DISTANCE OF 50 FEET. SIGN MATERIAL SHALL BE PLASTIC, METAL OR SIMILAR DURABLE MATERIAL. THE SIGN SHALL READ "EMERGENCY SHUT OFF." THE EMERGENCY SHUT OFF SWITCH SHALL BE RED IN COLOR AND OF THE MUSHROOM PUSH TO DE-ENERGIZE TYPE.</p> <p>ELECTRICAL CONTRACTOR SHALL COMPLY WITH THE MOST RECENTLY REVISED VERSIONS OF ALL APPLICABLE REQUIREMENTS OF LAWS, RULES, REGULATIONS, CODES AND ORDINANCES OF FEDERAL, STATE, AND LOCAL AUTHORITIES HAVING JURISDICTION</p> <p>ALL EQUIPMENT AND MATERIALS SHALL COMPLY WITH SAID AUTHORITIES WHETHER INDICATED ON THE CONTRACT DOCUMENTS OR NOT</p> <p>ELECTRICAL CONTRACTOR SHALL PROVIDE A DISCONNECTING MEANS PER NEC, (I.E. BREAKERS) FOR ALL ELECTRICAL EQUIPMENT</p> <p>THESE DRAWINGS ATTEMPT TO GIVE REASONABLE INDICATIONS OF THE LOCATIONS OF THE VARIOUS EQUIPMENT AND DEVICES - ELECTRICAL CONTRACTOR SHALL COORDINATE LOCATIONS WITH OTHER TRADES AND OWNER AS REQUIRED BY SITE CONDITIONS, AND ALL AUTHORITIES HAVING JURISDICTION</p> <p>ELECTRICAL CONTRACTOR SHALL COORDINATE ALL CONDUIT ROUTING WITH THE STRUCTURE, PIPING, AND OTHER EXISTING CONDITIONS AS REQUIRED FOR A COMPLETE, CONFLICT FREE INSTALLATION</p> <p>ALL CONDUIT SHALL RUN PARALLEL TO WALLS AND FLOORS - COORDINATE WITH OTHER TRADES</p> <p>PROVIDE EQUIPMENT GROUNDING CONDUCTOR SIZED PER NEC TABLE 250.122 IN ALL ELECTRICAL CONDUITS SERVING POOL EQUIPMENT, LIGHTING OR POWER IN POOL AREA</p> <p>A SEPARATE GREEN GROUND CONDUCTOR SHALL BE PROVIDED WITH ALL BRANCH AND FEEDER CIRCUITS, SIZE PER NEC 250.95, UNLESS NOTED OTHERWISE</p> <p>ALL SINGLE POLE CIRCUITS SHALL CONTAIN A SEPARATE NEUTRAL CONDUCTOR</p> <p>ELECTRICAL CONTRACTOR TO BOND ALL METAL WITHIN 15' OF SWIMMING POOLS, INCLUDING BUT NOT LIMITED TO: STEEL COLUMNS, WALLS, WINDOW FRAMES, DOORS, DOOR FRAMES, ALL METALLIC PLUMBING, ALL METALLIC POOL EQUIPMENT, AND REINFORCEMENT STEEL IN POOLS</p> <p>BOND WIRE TO BE #8 BARE COPPER</p>	<p><b>COVER</b> SP-N1 SP-N2 SP-1.0 SP-1.1 SP-1.2 SP-1.3 SP-1.4</p> <p><b>COVER SHEET, SITE MAP AND LEGEND</b> CONSTRUCTION NOTES, SHEETS, SPECIFICATIONS SPECIFICATIONS SHEETS OVERALL LAYOUT AND DIMENSIONS POOL DECK AND ENCLOSURE LAYOUT, DETAILS POOL PLUMBING AND BONDING LAYOUT POOL SECTIONS AND DETAILS EQUIPMENT ROOM LAYOUT</p> <p><b>ABBREVIATIONS</b></p> <table border="0"> <tr> <td>@</td> <td>AT</td> </tr> <tr> <td>Ø</td> <td>DIAMETER</td> </tr> <tr> <td>{4x}</td> <td>TOTAL QUANTITY OF ITEMS</td> </tr> <tr> <td>A.D.A.</td> <td>AMERICANS WITH DISABILITIES ACT</td> </tr> <tr> <td>A</td> <td>AMPS</td> </tr> <tr> <td>B-</td> <td>BACKWASH PLUMBING</td> </tr> <tr> <td>C.I.P.</td> <td>CAST IN PLACE</td> </tr> <tr> <td>C</td> <td>CENTERLINE</td> </tr> <tr> <td>C. TO C.</td> <td>CENTER TO CENTER</td> </tr> <tr> <td>CONT.</td> <td>CONTINUOUS</td> </tr> <tr> <td>C.J.</td> <td>CONTROL JOINT</td> </tr> <tr> <td>EA.</td> <td>EACH</td> </tr> <tr> <td>EXCV.</td> <td>EXCAVATION</td> </tr> <tr> <td>E.J.</td> <td>EXPANSION JOINT</td> </tr> <tr> <td>GAL.</td> <td>GALLONS</td> </tr> <tr> <td>G.P.M.</td> <td>GALLONS PER MINUTE</td> </tr> <tr> <td>H.P.</td> <td>HORSE POWER</td> </tr> <tr> <td>LN. FT.</td> <td>LINEAR FEET</td> </tr> <tr> <td>M-</td> <td>MAIN DRAIN PLUMBING</td> </tr> <tr> <td>MAX.</td> <td>MAXIMUM</td> </tr> <tr> <td>MIN.</td> <td>MINIMUM</td> </tr> <tr> <td>O.C.</td> <td>ON CENTER</td> </tr> <tr> <td>O.C.E.W.</td> <td>ON CENTER EACH WAY</td> </tr> <tr> <td>R</td> <td>RADIUS</td> </tr> <tr> <td>R</td> <td>RETURN PLUMBING</td> </tr> <tr> <td>REQ.</td> <td>REQUIRED</td> </tr> <tr> <td>S.V.R.S.</td> <td>SAFETY VACUUM RELEASE SYSTEM</td> </tr> <tr> <td>SQ. FT.</td> <td>SQUARE FEET</td> </tr> <tr> <td>S.S.</td> <td>STAINLESS STEEL</td> </tr> <tr> <td>S-</td> <td>SUCTION (SKIMMER) PLUMBING</td> </tr> <tr> <td>TH.</td> <td>THICKNESS</td> </tr> <tr> <td>T.B.D.</td> <td>TO BE DETERMINED</td> </tr> <tr> <td>T.B.F.V.</td> <td>TO BE FIELD VERIFIED</td> </tr> <tr> <td>TOT.</td> <td>TOTAL</td> </tr> <tr> <td>T.D.H.</td> <td>TOTAL DYNAMIC HEAD</td> </tr> <tr> <td>T.O.W.</td> <td>TOP OF WALL</td> </tr> <tr> <td>V</td> <td>VOLTS</td> </tr> <tr> <td>W</td> <td>WATTS</td> </tr> <tr> <td>W.L.</td> <td>WATER LINE</td> </tr> <tr> <td>W.P.</td> <td>WEATHER PROOF</td> </tr> </table>	@	AT	Ø	DIAMETER	{4x}	TOTAL QUANTITY OF ITEMS	A.D.A.	AMERICANS WITH DISABILITIES ACT	A	AMPS	B-	BACKWASH PLUMBING	C.I.P.	CAST IN PLACE	C	CENTERLINE	C. TO C.	CENTER TO CENTER	CONT.	CONTINUOUS	C.J.	CONTROL JOINT	EA.	EACH	EXCV.	EXCAVATION	E.J.	EXPANSION JOINT	GAL.	GALLONS	G.P.M.	GALLONS PER MINUTE	H.P.	HORSE POWER	LN. FT.	LINEAR FEET	M-	MAIN DRAIN PLUMBING	MAX.	MAXIMUM	MIN.	MINIMUM	O.C.	ON CENTER	O.C.E.W.	ON CENTER EACH WAY	R	RADIUS	R	RETURN PLUMBING	REQ.	REQUIRED	S.V.R.S.	SAFETY VACUUM RELEASE SYSTEM	SQ. FT.	SQUARE FEET	S.S.	STAINLESS STEEL	S-	SUCTION (SKIMMER) PLUMBING	TH.	THICKNESS	T.B.D.	TO BE DETERMINED	T.B.F.V.	TO BE FIELD VERIFIED	TOT.	TOTAL	T.D.H.	TOTAL DYNAMIC HEAD	T.O.W.	TOP OF WALL	V	VOLTS	W	WATTS	W.L.	WATER LINE	W.P.	WEATHER PROOF	<table border="1"> <thead> <tr> <th>TYPE / CLASS</th> <th>C (HOTEL)</th> </tr> </thead> <tbody> <tr> <td>DIMENSIONS</td> <td>14'-0" x 26'-0"</td> </tr> <tr> <td>WATER LINE PERIMETER</td> <td>90'-0"</td> </tr> <tr> <td>TOTAL PERIMETER IMPEDIMENT</td> <td>0%</td> </tr> <tr> <td>DEPTH</td> <td>3'-0" TO 4'-9"</td> </tr> <tr> <td>VOLUME</td> <td>12,000</td> </tr> <tr> <td>WATER SURFACE AREA</td> <td>400 SQ.FT.</td> </tr> <tr> <td>TOTAL INTERNAL SURFACE AREA</td> <td>760 SQ.FT.</td> </tr> <tr> <td>MAX. BATHER LOAD</td> <td>16 PPL</td> </tr> <tr> <td>TURNOVER RATE MAIN POOL</td> <td>3.33 HOURS (60 GPM @ 60' TDH)</td> </tr> <tr> <td>DECKING AREA</td> <td>1,187 SQ.FT.</td> </tr> <tr> <td>COPING - CAST STONE 12" x 24", COLOR T.B.D.</td> <td>96 LN FT</td> </tr> </tbody> </table> <p>HANDRAILS AND LADDERS - 1.9"Ø, 0.065" THICK 304 STAINLESS STEEL</p> <p>68" S.R. SMITH CUSTOM 3-BEND (1x) S.R. SMITH DADE-C FLORIDA COMMERCIAL LADDER (1x)</p> <p>ADA LIFT - ASPEN 2 OR EQUIVALENT POOLSIDE ADA LIFT (1x)</p> <p><b>PLUMBING AND EQUIPMENT</b></p> <p>WALL RETURNS - 1-1/2" PVC, 1/2" ORIFICE (2x) FLOOR RETURNS - STARITE/PENTAIR (0x) SKIMMERS - PENTAIR BERMUDA OR EQUAL (2x) MAIN DRAINS - 8" DIA. SUMP PENTAIR OR EQUAL (2x) FLOOR SUMPS MUST HAVE "VGB 2008" APPROVED ANTI-VORTEX GRATES 144 GPM MAX. FLOW @ &lt;1.5 FT/S VELOCITY</p> <p><b>FILTRATION:</b> PENTAIR CCP CARTRIDGE FILTER, 240 SQ. FT.</p> <p><b>FILTRATION PUMP:</b> PENTAIR WHISPERFLO 1 HP, 120/240V 1-PHASE</p> <p><b>SANITIZATION:</b> RAINBOW HC3315 OFFLINE 1" PVC SLIP STREAM SOLID TCCA TABLET FEED 90% AVAILABLE CL BY WEIGHT TRICHLORO-S-TRIAZINETRIONE 15 LBS STORAGE CAPACITY</p> <p>MAKEUP/AUTO FILL: PENTAIR/RAINBOW POOL MISER (FLOAT VALVE)</p> <p><b>TILE</b> WATERLINE - 2"x2" FROST PROOF CERAMIC TILE DEPTH MARKERS, 6"x6" w/4" LETTERING PER CODE (7 LOCATIONS) "NO DIVING" MARKERS, NON-SKID 6" TILE w/4" LETTERING PER CODE (7 LOCATIONS)</p> <p><b>HEATER</b> PENTAIR MASTERTEMP 125DS LoNox, NG ASME, 125 BTU</p>	TYPE / CLASS	C (HOTEL)	DIMENSIONS	14'-0" x 26'-0"	WATER LINE PERIMETER	90'-0"	TOTAL PERIMETER IMPEDIMENT	0%	DEPTH	3'-0" TO 4'-9"	VOLUME	12,000	WATER SURFACE AREA	400 SQ.FT.	TOTAL INTERNAL SURFACE AREA	760 SQ.FT.	MAX. BATHER LOAD	16 PPL	TURNOVER RATE MAIN POOL	3.33 HOURS (60 GPM @ 60' TDH)	DECKING AREA	1,187 SQ.FT.	COPING - CAST STONE 12" x 24", COLOR T.B.D.	96 LN FT
@	AT																																																																																																									
Ø	DIAMETER																																																																																																									
{4x}	TOTAL QUANTITY OF ITEMS																																																																																																									
A.D.A.	AMERICANS WITH DISABILITIES ACT																																																																																																									
A	AMPS																																																																																																									
B-	BACKWASH PLUMBING																																																																																																									
C.I.P.	CAST IN PLACE																																																																																																									
C	CENTERLINE																																																																																																									
C. TO C.	CENTER TO CENTER																																																																																																									
CONT.	CONTINUOUS																																																																																																									
C.J.	CONTROL JOINT																																																																																																									
EA.	EACH																																																																																																									
EXCV.	EXCAVATION																																																																																																									
E.J.	EXPANSION JOINT																																																																																																									
GAL.	GALLONS																																																																																																									
G.P.M.	GALLONS PER MINUTE																																																																																																									
H.P.	HORSE POWER																																																																																																									
LN. FT.	LINEAR FEET																																																																																																									
M-	MAIN DRAIN PLUMBING																																																																																																									
MAX.	MAXIMUM																																																																																																									
MIN.	MINIMUM																																																																																																									
O.C.	ON CENTER																																																																																																									
O.C.E.W.	ON CENTER EACH WAY																																																																																																									
R	RADIUS																																																																																																									
R	RETURN PLUMBING																																																																																																									
REQ.	REQUIRED																																																																																																									
S.V.R.S.	SAFETY VACUUM RELEASE SYSTEM																																																																																																									
SQ. FT.	SQUARE FEET																																																																																																									
S.S.	STAINLESS STEEL																																																																																																									
S-	SUCTION (SKIMMER) PLUMBING																																																																																																									
TH.	THICKNESS																																																																																																									
T.B.D.	TO BE DETERMINED																																																																																																									
T.B.F.V.	TO BE FIELD VERIFIED																																																																																																									
TOT.	TOTAL																																																																																																									
T.D.H.	TOTAL DYNAMIC HEAD																																																																																																									
T.O.W.	TOP OF WALL																																																																																																									
V	VOLTS																																																																																																									
W	WATTS																																																																																																									
W.L.	WATER LINE																																																																																																									
W.P.	WEATHER PROOF																																																																																																									
TYPE / CLASS	C (HOTEL)																																																																																																									
DIMENSIONS	14'-0" x 26'-0"																																																																																																									
WATER LINE PERIMETER	90'-0"																																																																																																									
TOTAL PERIMETER IMPEDIMENT	0%																																																																																																									
DEPTH	3'-0" TO 4'-9"																																																																																																									
VOLUME	12,000																																																																																																									
WATER SURFACE AREA	400 SQ.FT.																																																																																																									
TOTAL INTERNAL SURFACE AREA	760 SQ.FT.																																																																																																									
MAX. BATHER LOAD	16 PPL																																																																																																									
TURNOVER RATE MAIN POOL	3.33 HOURS (60 GPM @ 60' TDH)																																																																																																									
DECKING AREA	1,187 SQ.FT.																																																																																																									
COPING - CAST STONE 12" x 24", COLOR T.B.D.	96 LN FT																																																																																																									

**REYNA DESIGN, LLC**  
O: 512.687.7869 C: 512.786.7814  
WWW.REYNADESIGN.US



EMERALD POOLS AND SPAS  
1139 River Park  
SAN ANTONIO, TX  
PHONE: 210.514.8269

JCR

CONSTRUCTION NOTES, SHEETS AND SPECIFICATIONS

**COMFORT SUITES**

SWIMMING POOL SHOP DRAWINGS  
5213 PHYSICIAN'S WAY, KYLE, TX 78640

PERMIT SET 05.11.2016

NOTES AND SPECS  
SCALE: SHEET:  
N/A SP-N1

**EQUIPMENT SPECIFICATIONS**

## WHISPERFLO® HIGH PERFORMANCE PUMP



Cam and Ramp™ Lid makes inspection and cleaning easy and quick

Heavy-duty threading for dependable worry-free connections

Durable, commercial-grade motor never needs lubrication

Oversized strainer basket extends time between cleanings

**QUIET. EFFICIENT. DURABLE.**

The WhisperFlo pump delivers maximum circulation efficiency at the lowest operating cost, and long, trouble-free life with minimal maintenance. Our legendary hydraulic design has been refined over 40 years for superior performance. No wonder more than 2 million Pentair pumps have been selected by pool professionals.

- Advanced FunnelFlo™ Diffuser and high-efficiency impeller maximize water flow and energy efficiency while minimizing turbulence and noise.
- Energy-efficient motor with commercial-grade frame, rustproof stainless steel shaft and permanently lubricated, sealed bearings for long life.
- Available in single-speed and two-speed models.
- Ideal for pool and spa combinations and for operating in-floor cleaning systems.
- One-year limited warranty. See warranty for details.

**PERFORMANCE CURVES**



**AVAILABLE FROM:**

**PENTAIR**

1620 HAWKINS AVE., SANFORD, NC 27330 800.831.7133 WWW.PENTAIRPOOL.COM

All Pentair trademarks and logos are owned by Pentair, Inc. WhisperFlo®, Cam and Ramp™ and FunnelFlo™ are trademarks and/or registered trademarks of Pentair Water Pool and Spa, Inc. and/or its affiliated companies in the United States and/or other countries. Because we are continuously improving our products and services, Pentair reserves the right to change specifications without prior notice. Pentair is an equal opportunity employer.

pumps • filters • heaters • heat pumps • automation • lighting • cleaners • sanitizers • water features • maintenance products

10/13 Part # P1-222 ©2013 Pentair Water Pool and Spa, Inc. All rights reserved.

## CLEAN & CLEAR® PLUS CARTRIDGE FILTER



Clamp ring for easy and quick access to cartridges

Single-piece fiberglass-reinforced polypropylene tank for strength and corrosion resistance

2" plumbing for maximum flow and faster water cleaning

Easy access 1 1/2" drain makes proper winterization fast and simple

**FOUR CARTRIDGES IN A COMPACT DESIGN**

Clean & Clear Plus filters contain four polyester cartridges that hold enormous amounts of dirt, yet are easier to clean. The fiberglass-reinforced tank halves are secured with an innovative clamp ring—just loosen the ring and remove the top half for easy cartridge access and rinsing. Filter maintenance doesn't get any easier.

- Continuous internal air bleed helps prevent air build-up to keep the filter operating at peak performance.
- Single-piece base and body for strength, stability and years of dependable service.
- One-year limited warranty. See warranty for details.

Model Number	Filter Area Sq. Ft.	Vertical Clearance*	Filter Diameter	Flow Rate GPM		Turnover Capacity-Res. (Gallons)		
				Res.**	Comm.	8 hrs.	10 hrs.	12 hrs.
CCP240	240	56"	21.5"	90	90	43,200	54,000	64,800
CCP320 <sup>1</sup>	320	62"	21.5"	120	120	57,600	72,000	86,400
CCP420 <sup>1</sup>	420	68"	21.5"	150	150	72,000	90,000	108,000
CCP520 <sup>1</sup>	520	74"	21.5"	150	150	72,000	90,000	108,000

<sup>1</sup>NSF Listed  
\*Required clearance to remove filter elements  
\*\*Maximum flow rate

**AVAILABLE FROM:**

**PENTAIR**

1620 HAWKINS AVE., SANFORD, NC 27330 800.831.7133 WWW.PENTAIRPOOL.COM

All Pentair trademarks and logos are owned by Pentair, Inc. Clean & Clear® and Eco Select® are registered trademarks of Pentair Water Pool and Spa, Inc. and/or its affiliated companies in the United States and/or other countries. Because we are continuously improving our products and services, Pentair reserves the right to change specifications without prior notice. Pentair is an equal opportunity employer.

pumps • filters • heaters • heat pumps • automation • lighting • cleaners • sanitizers • water features • maintenance products

1/13 Part # P1-131 ©2013 Pentair Aquatic Systems. All rights reserved.

## RAINBOW™ HIGH CAPACITY CHLORINE/ BROMINE FEEDERS



- Designed for ease of use and simple maintenance
- Drain valve allows easier draining for safer recharging or winterizing
- Standard threaded inlet and outlet fittings included for easy installation

**THE PERFORMANCE LEADER IN AUTOMATIC SANITIZATION FOR LARGE RESIDENTIAL AND COMMERCIAL POOLS**

The INLET control valve side of the feeder connects to the discharge side of the pump, before the filter. The OUTLET side of the feeder connects to the pool return line after the filter and/or heater, pool cleaner, diverter valves, or any other installed equipment. Installation of a corrosion-resistant check valve such as #R172288 by Pentair between the feeder inlet and outlet and the equipment is strongly recommended to check backflow of chemicals. This helps ensure equipment longevity.

**MODELS & SPECIFICATIONS**

Model	HC-3315	HC-3330	HC-3340	
Part Number	R171215	R171230	R171240	
Height	21.5"	39.125"	49.75"	
Width	8"	8"	8"	
Depth	15"	15"	15"	
Maintenance Clearance	22.75"	40.375"	51"	
Capacity (lbs.)	15	30	40	
① 10% Setting	Flow rate (GPM)	34	34	11.5
	Maximum Output Rate, Chlorine <sup>1</sup> (lbs./hr.)-Pool at listed flowrate	2.8	4.6	3.0
	Maximum Output Rate, Chlorine <sup>1</sup> (lbs./hr.)-Spa at listed flowrate	4.8	7.9	5.7
	Maximum Output Rate, Bromine <sup>1</sup> (lbs./hr.)-Pool at listed flowrate	1.3	2.7	1.7
② 50% Setting	Flow rate (GPM)	17.8	17.8	9.2
	Output Rate, Chlorine <sup>1</sup> (lbs./hr.)-Pool at listed flowrate	2.1	3.4	2.6
	Output Rate, Chlorine <sup>1</sup> (lbs./hr.)-Spa at listed flowrate	1.8	3.0	5.4
	Output Rate, Bromine <sup>1</sup> (lbs./hr.)-Pool at listed flowrate	1.0	2.0	1.5
Maximum Pool Size @ 34 GPM (Chlorine-Gals)	224,000	349,000	658,500	
Maximum Pool Size @ 34 GPM (Bromine-Gals)	99,200	164,000	292,600	

<sup>1</sup>Maximum working pressure - 50 psi  
<sup>2</sup>Results based on use of 1" Trichlor tablets

**AVAILABLE FROM:**

**PENTAIR**

1620 HAWKINS AVE., SANFORD, NC 27330 800.831.7133 WWW.PENTAIRPOOL.COM

All Pentair trademarks and logos are owned by Pentair, Inc. Rainbow™ is a trademark of Pentair Water Pool and Spa, Inc. and/or its affiliated companies in the United States and/or other countries. Because we are continuously improving our products and services, Pentair reserves the right to change specifications without prior notice. Pentair is an equal opportunity employer.

pumps • filters • heaters • heat pumps • automation • lighting • cleaners • sanitizers • water features • maintenance products

2/13 Part # RS-1012 ©2013 Pentair Aquatic Systems. All rights reserved.



**TILE Specialist** Technical Specifications and Product Info Sheet  
Phone: (800)404-5254 Fax: (386)454-1844

**Part # NC6FWP-SYMRNDRED**  
Flat 6x6 Smooth Round No Diving Symbol Red & Black

**Part # NC2FDP-NODIVING**  
Flat 6x12 Skid Resistant w/4 inch NO DIVING

**NO DIVING**

**Part # DC6FDP4-03**  
Flat 6x6 Skid Resistant w/4 inch #3

**Part # DC6FWP4-TOP06**  
Flat 6x6 Smooth w/4 inch #6 (At Top Of Tile)

**Part # DC6FWP4-TOPFT**  
Flat 6x6 Smooth w/4 inch FT (At Top Of Tile)

**3 FT.**

**DECK TILES**      **POOL WATERLINE TILES**

**Technical Specifications - All Tiles**

6x6 Flat Tiles	6x12 Flat Tiles	Bullnose, Logo, Signature & Step Tiles
Actual tile size: - 5-13/16 in square x 3/16 in thick - 14.9 cm square x 0.5 cm thick	Actual tile size: - 5-13/16 in x 11-13/16 in x 9/32 in thick - 14.9 cm x 30.0 cm x 0.75 cm thick	6x6 bullnose tiles: - Industry format A3602 - Weight: 0.75 lbs
Other Specs: - Weight: 0.683 lbs - Water absorption: <= 1.5% (EN 99) - Breaking strength: >= 40 N/mm <sup>2</sup> (EN 100)	Other Specs: - Weight: 1.4 lbs - Water absorption: <= 1.5% (EN 99) - Breaking strength: >= 40 N/mm <sup>2</sup> (EN 100)	Logo and Signature Tiles: - 3-3/4" and 4-1/4" flat tiles - Non frostproof - Frostproof
Coefficient of friction (skid resistant only): - Dry: >= 0.9 (ASTM C1028) - Wet: >= 0.9 (ASTM C1028)	Coefficient of friction (skid resistant only): - Dry: >= 0.9 (ASTM C1028) - Wet: >= 0.9 (ASTM C1028)	Step Tiles: Industry format A4200, 2" x 6" - Weight: 0.4 lbs - Dry: >= 0.9 (ASTM C1028) - Wet: >= 0.9 (ASTM C1028)

**Blue-White Industries, Ltd.** Pitot Tube Insertion Meters  
Engineering and Technical Data

**F-300**  
**U-300**  
**D-300**

2" FLOW METER

Clamp-on Insertion Mount  
Dual GPM / LPM scale

**Features:**

- Dual GPM/LPM scale printed on both sides of the meter.
- 1" through 8" pipe sizes.
- Flow rateS from 2 to 1900 GPM (8 to 7200 LPM).
- Corrosion resistant 316SS or Teflon internal float materials.
- One piece machined acrylic body.
- Mounts to existing pipe. No unions or adapters required.
- Models for mounting on horizontal or vertical pipe.
- Mounting clamps and gasket included.

**Specifications:**

Pipe Requirements: ..... IPS inch pipe size (ASTM-D-1785)  
 Max. Psi (bar): ..... 150 PSI (10.3 bar) @ 70° F (21° C)  
 Max. fluid temp.: ..... 190° F (88° C) @ 0 PSI  
 Max. ambient temp.: ..... 14° to 110° F (-10° to 43° C)  
 Note: Temperature & Pressure ratings of meter only. Actual pipe rating may vary.

Full scale accuracy: ..... +/- 10%  
 Power requirement: ..... No power required  
 Enclosure: ..... NEMA 4X (IP56)  
 Approximate shipping wt.: ... 1"-4" models: 1 lb. (.45 kg)  
 6"-8" models: 2 lb. (.91 kg)

**Materials of Construction:**

Meter Body: ..... Cast Acrylic  
 Float: ..... Standard range models = 316SS  
 Low range models = Teflon

Gasket: ..... Neoprene  
 Pipe Clamp: ..... 300 series Stainless Steel  
 Pipe screw: ..... 1" thru 2" models only. 300 series stainless Steel

**Installation Requirements:**

**Minimum Straight Pipe Length Requirements**  
 The meter's accuracy is affected by disturbances such as pumps, elbows, tees, valves, etc., in the flow stream. Install the meter in a straight run of pipe as far as possible from any disturbances. The distance required for accuracy is 10 times the nominal pipe diameter before the meter and 4 times the nominal pipe diameter after the meter.

**Example of Minimum Straight Pipe Length Requirements**

Nominal Pipe Diameter	Minimum Inlet Pipe Length	Minimum Outlet Pipe Length
3 inch	30 inch (10 x 3")	12 inch (4 x 3")
1-1/2 inch	15 inch (10 x 1.5")	6 inch (4 x 1.5")
6 inch	60 inch (10 x 6")	24 inch (4 x 6")

**Mounting location**

- The meter is designed to withstand outdoor conditions.
- F series meters must be mounted at the vertical (twelve o'clock) position on horizontal pipe only.
- U & D series meters must be mounted on vertical pipe only.
- The pipe must be completely full of water at all times.
- See the minimum straight length of pipe requirement chart above.
- The meter can accurately measure flow from one direction only.
- U-series meters measure upward flows only.
- D-series meters measure downward flows only.

**Tru Flo Covers and Frames**

**Tru Flo 8" Covers and Frames**

Part No.	Description	Case Weight	Case Quantity
640-18xx V	8" Tru Flo Cover & Frame	17.67 lbs.	25

**Concrete Sump Bodies & Assemblies**

**Concrete Bodies and Assemblies - Side x Bottom**

Part No.	Description	Case Quantity
672-2410	8" Sump Body - Concrete - 1 1/2" S	7
672-2500	8" Sump Body - Concrete - 2" FPT	7
672-2510	8" Sump Body - Concrete - 2" S	7
640-8300 V	8" Sump Assembly - Concrete - 1 1/2" S - with 8" Tru Flo Drain Cover	8
640-8500 V	8" Sump Assembly - Concrete - 2" S - with 8" Tru Flo Drain Cover	8
640-8700 V	8" Sump Assembly - Concrete - 2" FPT - with 8" Tru Flo Drain Cover	8

**INTELLIBRITE® 5G WHITE LED**  
COMMERCIAL WHITE LIGHTING

Available in 300, 400 and 500 watt incandescent light brightness equivalents.

**Energy Output in Watts**

Incandescent Light	IntelliBrite 5g White LED Light
300 Watts	40 Watts
400 Watts	48 Watts
500 Watts	55 Watts

**An Eco Select® Brand Product**

LED (Light Emitting Diode) pool and spa lights are the most energy efficient pool and spa lighting option available. That's why IntelliBrite 5g white LED lights are an Eco Select brand product.

The Eco Select brand identifies our "greenest" and most efficient equipment choices. These products save energy, conserve water, eliminate noise, or otherwise contribute to a more environmentally responsible equipment system.

As the global leader in pool and spa equipment manufacturing, we strive to provide greener choices for our customers. We hope you will join us in embracing more eco-friendly poolscapes by choosing Eco Select branded products for your swimming pool.

**Specialty Controls**

**Need a Code-Compliant Transformer for your LEDs?**  
We've Got the Bright Ideas

**NEW**

**NEW**

**PX50, PX100, PX300, & PX600 Series Safety Transformers**

- Supply 12 volts to pool/spa lights, submersible fixtures, and outdoor garden lights
- Mounting brackets on the top and bottom

3R Beige Steel Enclosure			
Model #	Input Voltage	Output Voltage	Watts
A. PX50	120 VAC, 1/2 Amp	12 or 13 VAC	50
PX100	120 VAC, 1 Amp	12 or 13 VAC	100
PX300	120 VAC, 3 Amp	12, 13, or 14 VAC	300
B. PX600	120 VAC, 6 Amp	12, 13, or 14 VAC	600

3R Stainless Steel Enclosure			
Model #	Input Voltage	Output Voltage	Watts
C. PX50S	120 VAC, 1/2 Amp	12 or 13 VAC	50
PX100S	120 VAC, 1 Amp	12 or 13 VAC	100
PX300S	120 VAC, 3 Amp	12, 13, or 14 VAC	300
D. PX600S	120 VAC, 6 Amp	12, 13, or 14 VAC	600

**Rating:**  
 PX50S, PX100S, PX300S  
 Size: 7 1/2" (18.4 cm) H x 5 1/2" (13.3 cm) W x 4 1/2" (11.4 cm) D  
 Knockouts:  
 Front: (2) combination 1/2" - 3/4"  
 Bottom: (4) combination 1/2" - 3/4"  
 Left: (2) combination 1/2" - 3/4"  
 Back: (2) combination 1/2" - 3/4"  
 Right: (2) combination 1/2" - 3/4"  
 PX600S  
 Size: 10" (25.4 cm) H x 10" (25.4 cm) W x 5" (12.7 cm) D  
 Knockouts:  
 Bottom: (2) combination 1/2" - 3/4" (4) combination 1/2" - 1"  
 Left: (2) combination 1/2" - 3/4"  
 Back: (2) combination 1/2" - 3/4"  
 Right: (2) combination 1/2" - 3/4"

**PENTAIR**

1620 HAWKINS AVE, SANFORD, NC 27330 800.831.7133 WWW.PENTAIRCOMMERCIAL.COM

All Pentair trademarks and logos are owned by Pentair or one of its global affiliates. Eco Select® and IntelliBrite® are registered trademarks of Pentair Water Pool and Spa, Inc. and/or its affiliated companies in the United States and/or other countries. Because we are continuously improving our products and services, Pentair reserves the right to change specifications without prior notice. Pentair is an equal opportunity employer.

2/14 Part # P1-082 ©2014 Pentair Water Pool and Spa, Inc. All rights reserved.

**INTERMATIC** **T100 Series**  
Electromechanical Time Switches

**T100 Series**  
The T100 Series Mechanical Time Switches are heavy-duty switches that have the highest horsepower ratings in the industry for industrial, commercial and residential applications.

**Features**

- Provides direct 24-Hour control of most loads
- Control electrical loads up to 40 Amps
- 1 to 12 ON/OFF operations each day
- Minimum ON/OFF times of 1 hour
- Manual override
- All models equipped with one ON and one OFF tripper

**Enclosure Type:** See table  
**Knockouts:** Combination 1/2" - 3/4" nominal knockouts, one on back and on each side, and two on bottom  
**Switch Type:** See table  
**Switch Rating:** Each Pole  
 40 Amp Resistive, 120-480 VAC  
 40 Amp Tungsten, Inductive or 1000 VA Pilot Duty, 120-277 VAC  
 2 HP (24 FLA) 120 VAC  
 5 HP (28 FLA) 240 VAC single-phase  
**Power Input:** 3 W Maximum  
**Operating Temperature:** -40°F to 130°F (-40°C to 54°C)  
**Shipping Weight:** Type 1 - 3 lbs. (1.4 kg)  
 Type 3R - 4 lbs. (1.8 kg)  
**Warranty:** Limited 1 year

Model with Type 1 Steel Enclosure	Model with Type 3R Steel Enclosure	Model with Type 3R Plastic Enclosure	Model with Type 3R Plastic Enclosure with See Through Cover	Switch Type	Clock Motor Volts	Hz	Amps/ Pole	HP Rating
T101	T101R	T101P	T101PCD82	SPST	125	60	40	2
T102	T102R	T102P	-	SPST	208-277	60	40	5
T103	T103R	T103P	T103PCD82	DPST	125	60	40	2
T104	T104R	T104P	T104PCD82	DPST	208-277	60	40	5
T104-50	-	-	-	DPST	208-277	50	40	5
T101B**	-	-	-	SPST	125	60	40	2
T105	-	-	-	1NO/1NC*	125	60	40	2
N/A	T106R	-	-	1NO/1NC*	208-277	60	40	5

\*Can be wired SPDT  
 \*\*Separate Clock Motor Terminals

**Electronic Controls**

**PERMIT SET** 05.11.2016

**COMFORT SUITES**  
SWIMMING POOL SHOP DRAWINGS  
5213 PHYSICIAN'S WAY, KYLE, TX 78640

**INTERMATIC** Energy Controls

**REYNA DESIGN, LLC**  
O: 512.687.7869 C: 512.786.7814  
WWW.REYNADESIGN.US

**EMERALD POOLS AND SPAS**  
1139 River Park  
SAN ANTONIO, TX  
PHONE: 210.514.8269

**Specification Sheets**

**COMFORT SUITES**

PERMIT SET 05.11.2016

SCALE: SHEET: N/A SP-N2



**KEYED NOTES:**

- 01 '911' EMERGENCY PHONE SHALL LOCATION - PHONE NEEDS TO IMMEDIATELY SUMMON EMERGENCY PERSONNEL, PER CODE
- 02 "NO LIFEGUARD ON DUTY" SIGN, AND "NO DIVING" SIGN TO BE DISPLAYED, PER CODE
- 03 SAFETY EQUIPMENT TO INCLUDE (1) BODY HOOK W/FIBERGLASS POLE AND (1) THROWING ROPE W/24" RING BUOY, PER CODE
- 04 ADA COMPLIANT DRINKING FOUNTAIN SHALL BE PROVIDED, PER CODE
- 05 HOSE BIBS, (BY OTHERS) PROVIDE BACKFLOW PREVENTION DEVICE TO ALL THREADED HOSE BIBS

**ADDITIONAL NOTES:**

SURFACE AREA FOR POOL DECK - APPROXIMATELY 1,187 SQ.FT. SEE SHEET SP-1.1 FOR DECK LIGHTING

MAIN DRAIN COVERS TO COMPLY WITH ANSI/ASME A112.19.8 - 2007 STANDARD, IN FULL EFFECTIVE DATE DECEMBER 19, 2008

REFER TO ARCHITECTURAL PLANS FOR DECK LAYOUT INCLUDING SLOPES, DRAINAGE, FINISH SCHEDULE, ETC.

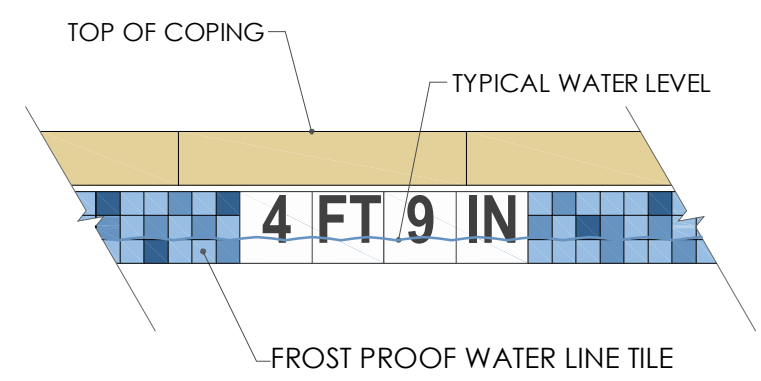
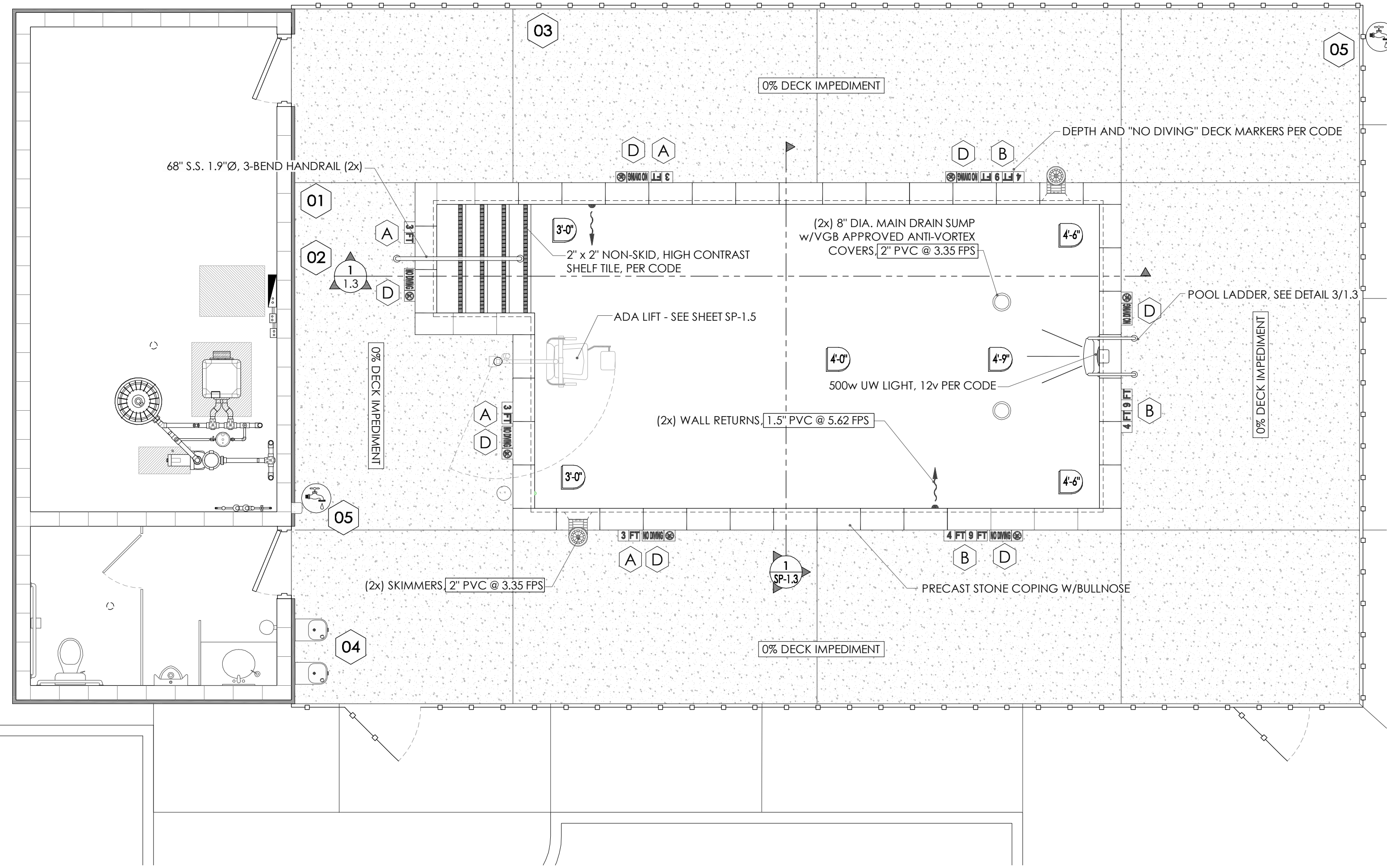

VERTICAL WALL DEPTH MARKER TILES TO BE 6" TALL W/4" TALL LETTERING, HIGH CONTRAST, GLAZED CERAMIC TILE, SET INTO POOL WALL AT WATER LINE. QUANTITY AND LOCATION REQUIRED TO MEET ALL APPLICABLE CODES.

NON-SKID DECK TILES			
3 FT	A	4 LOCATIONS	
4 FT 9 IN	B	3 LOCATIONS	
NO DIVING	D	7 LOCATIONS	

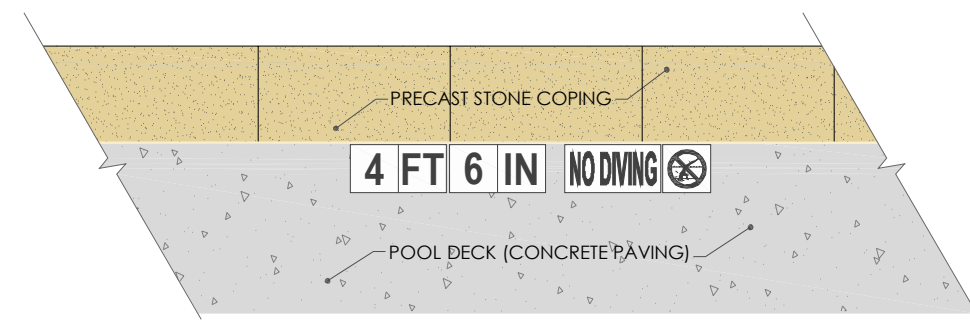

DEPTH AND "NO DIVING" SIGNAGE SHALL CONSIST OF 4" HIGH LETTERING, HIGH CONTRAST, NON-SKID TILES. QUANTITY AND LOCATION REQUIRED TO MEET ALL APPLICABLE CODES. DEPTHS SHOWN ON PLAN. DEPTH MARKERS ARE REQUIRED AT ALL CORRESPONDING LOCATIONS TO THOSE IN VERTICAL WALL OF POOL.



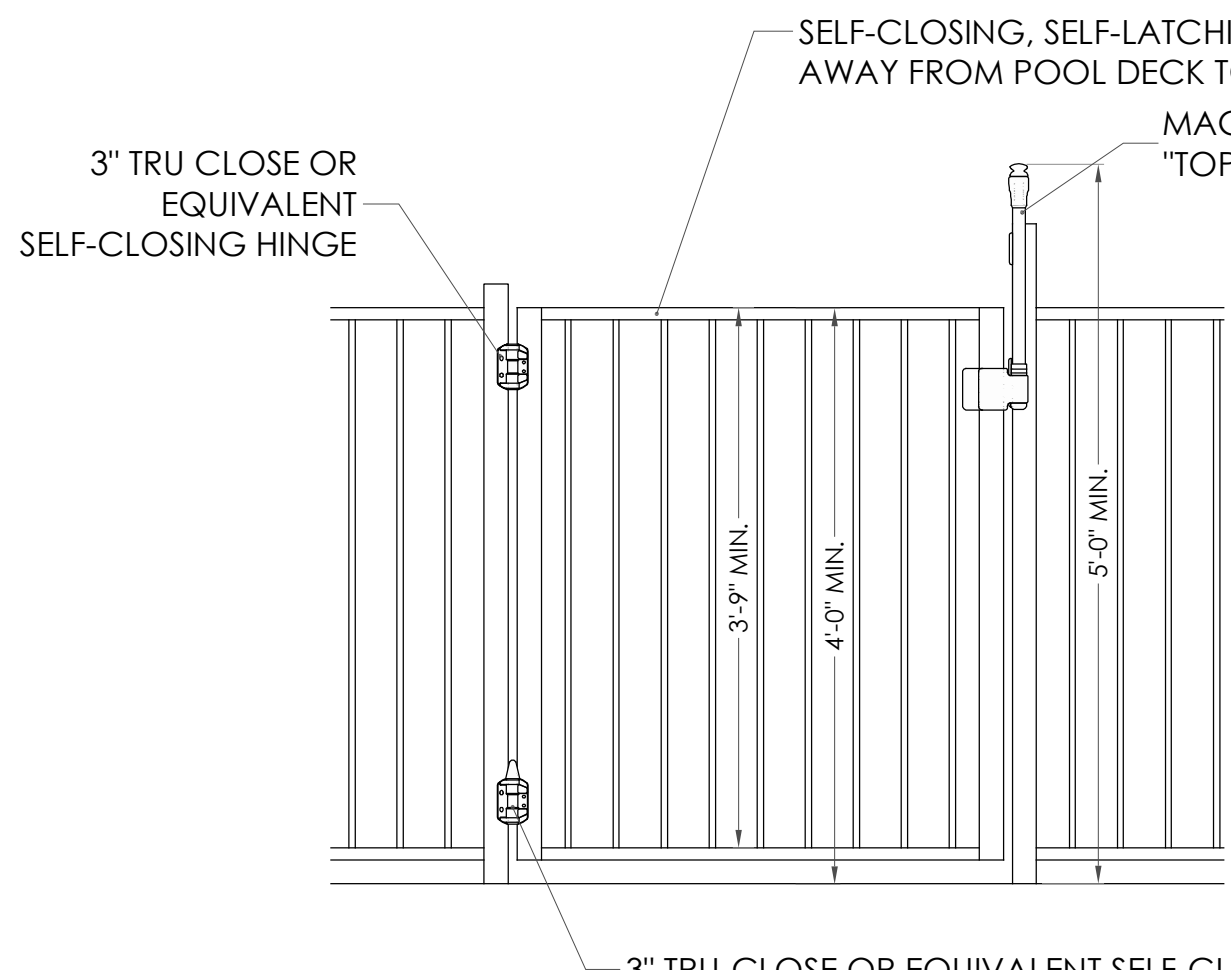

**GATE DETAILS**  
SCALE: 3/4" = 1' - 0"

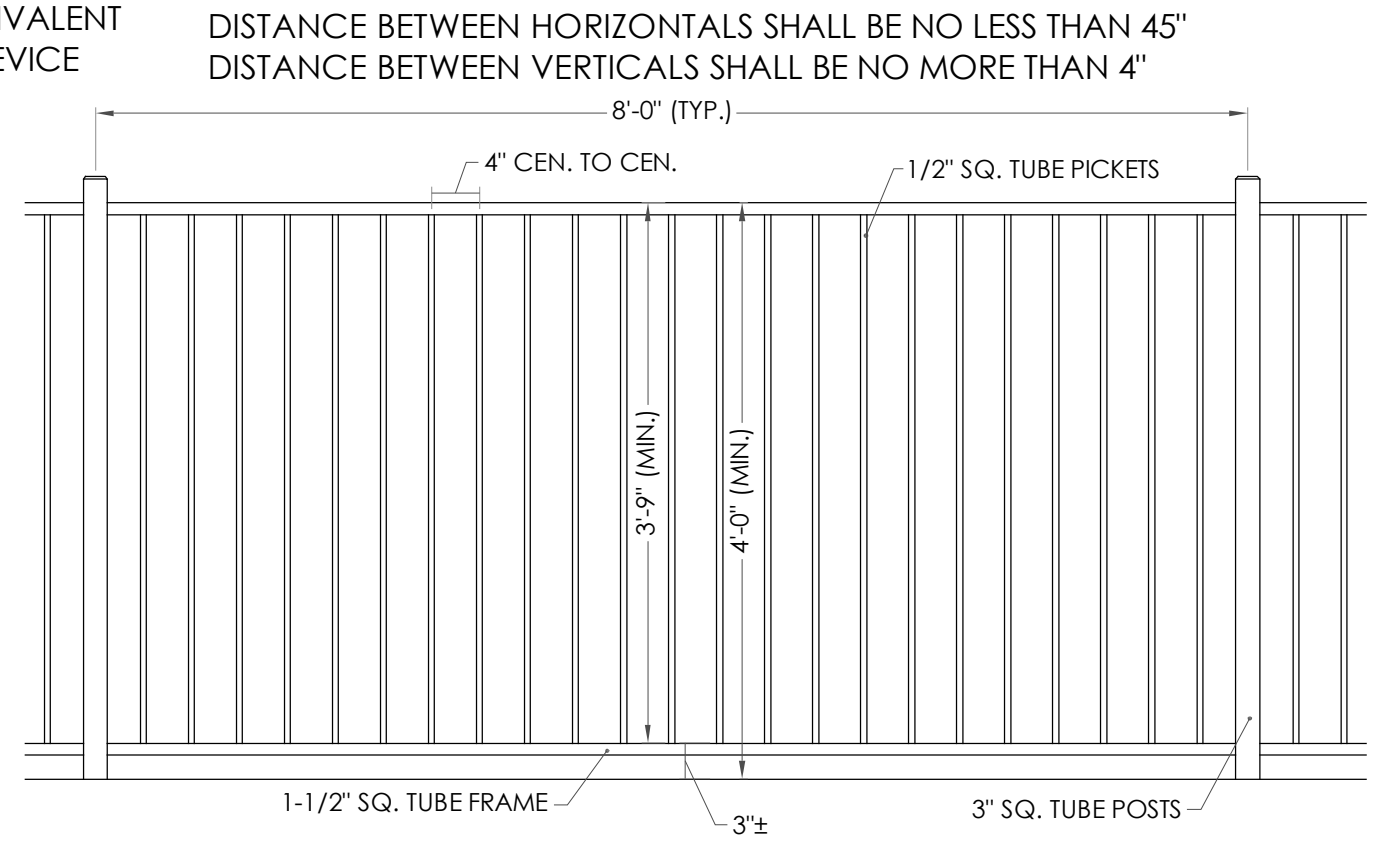

**TYPICAL FENCE ELEVATION**  
SCALE: 3/4" = 1' - 0"

ALL WELDS SHALL BE SMOOTHED, ALL BURRS/SHARP EDGES SHALL BE SANDED  
ALL METAL FENCING, GATES, ETC. SHALL BE PAINTED. REFER TO ARCH. SPECS

- KEYED NOTES:
- 01 SELF-CLOSING, SELF-LATCHING GATE PER CODE. KEYCARD ACCESS FROM OUTSIDE. SEE SHEET SP-1.5 FOR GATE HARDWARE AND DETAILS
  - 02 DOOR TO REMAIN LOCKED - MAINTENANCE STAFF ACCESS ONLY. SEE ARCHITECTURAL PLANS FOR DOOR HARDWARE AND DETAILS.

GENERAL ENCLOSURE NOTES:  
ENCLOSURE MUST BE 48" HEIGHT MINIMUM  
ALL POOL ACCESS POINTS SHALL MEET TEXAS HEALTH AND SAFETY CODE CH. 757,  
48" HIGH (MIN.) SELF-CLOSING, SELF-LATCHING GATES PER CODE.

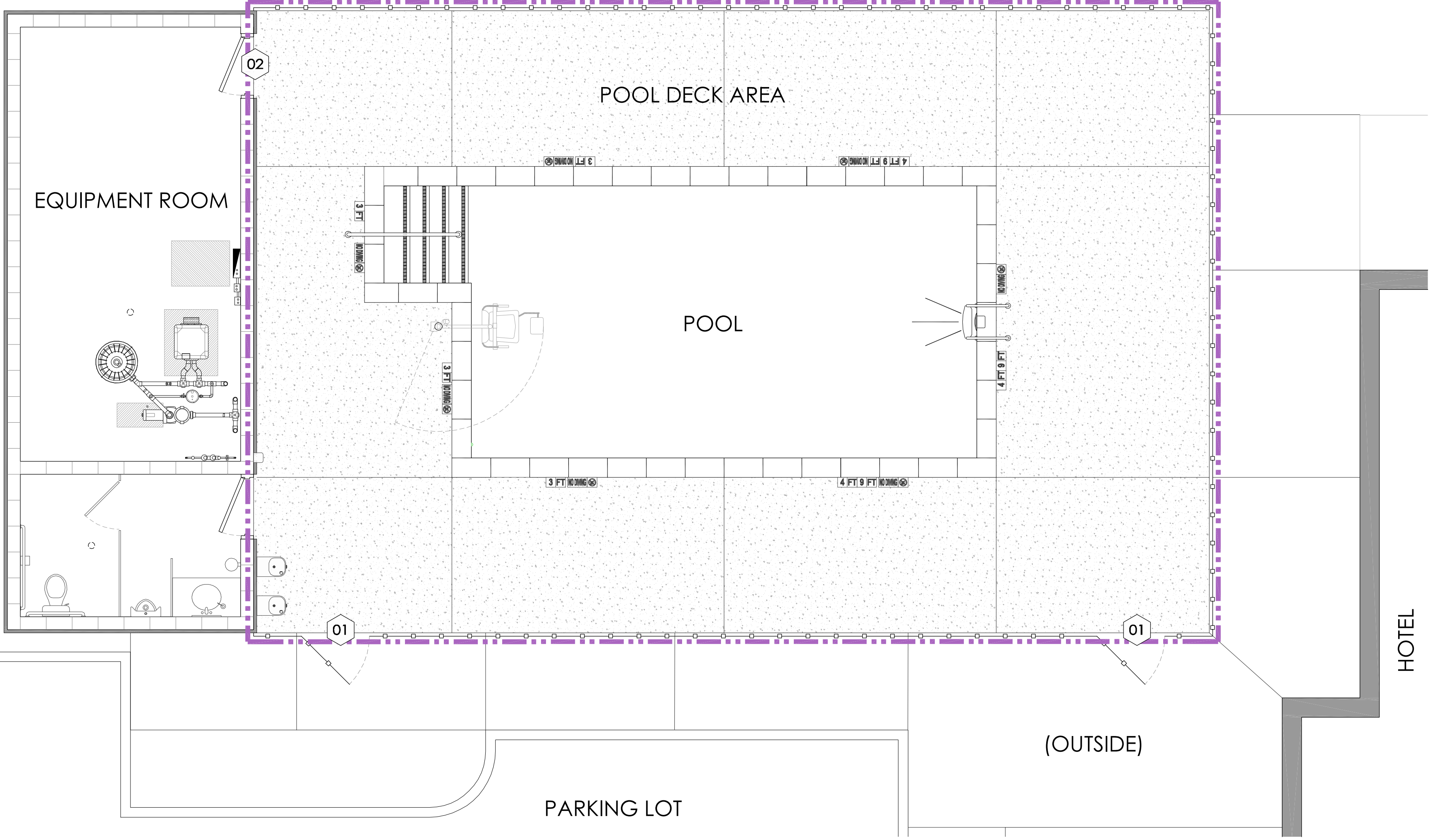

THIS DRAWING, ALL INFORMATION CONTAINED WITHIN, AND ALL SUBMITTED INFORMATION RELATING TO THIS DRAWING, IS THE PROPERTY OF REYNA DESIGN. POSSESSION, USE, OR DUPLICATION BY ANYONE OTHER THAN THE INTENDED RECIPIENT(S), OR WITHOUT EXPLICIT AUTHORIZATION IS PROHIBITED BY LAW AND SUBJECT TO PROSECUTION.



MAIN DRAIN COVERS TO COMPLY WITH ANSI/ASME A112.19.8 - 2007 STANDARD, IN FULL EFFECTIVE DATE DECEMBER 19, 2008

POOL LIGHT J.BOXES SHALL BE 18" ABOVE TOP OF COPING. ACTUAL LOCATIONS TBFV

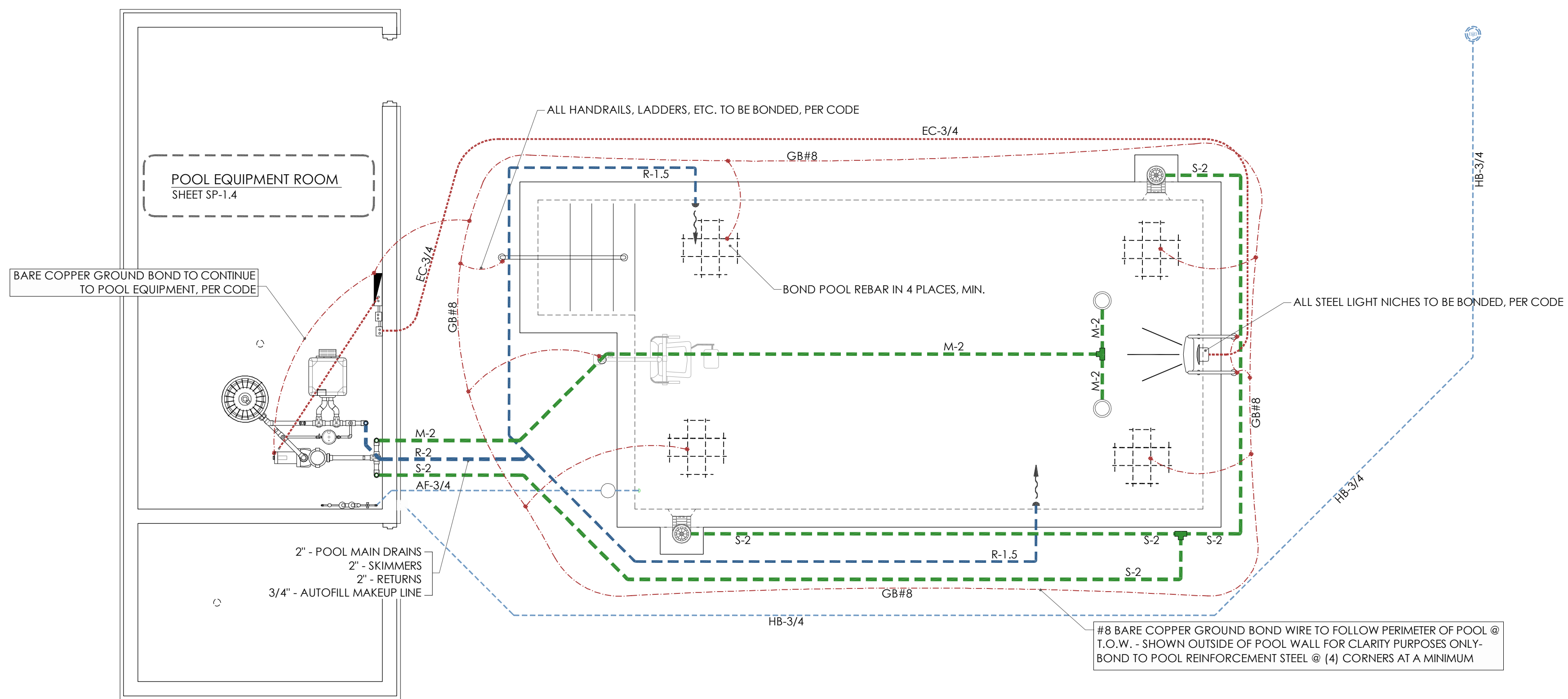

THIS DRAWING, ALL INFORMATION CONTAINED WITHIN, AND ALL SUBMITTED INFORMATION RELATING TO THIS DRAWING, IS THE PROPERTY OF REYNA DESIGN. POSSESSION, USE, OR DUPLICATION BY ANYONE OTHER THAN THE INTENDED RECIPIENT(S), OR WITHOUT EXPLICIT AUTHORIZATION IS PROHIBITED BY LAW AND SUBJECT TO PROSECUTION.



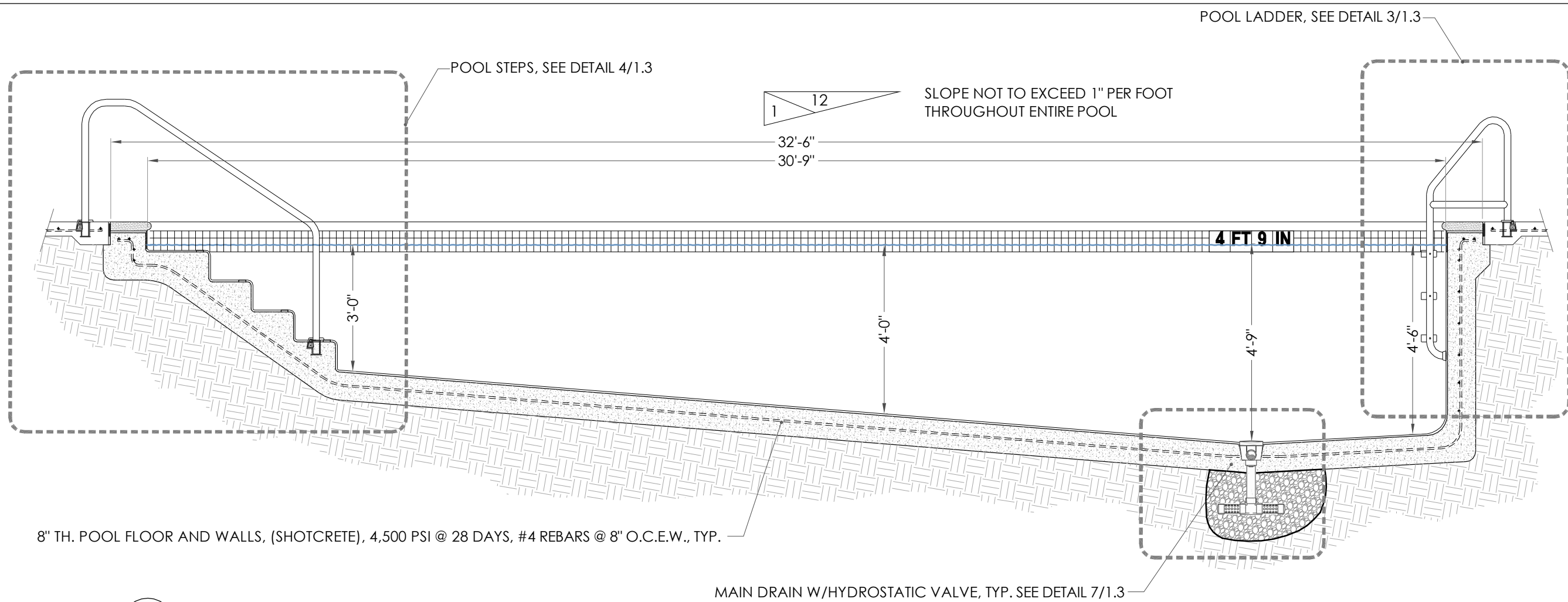

8" TH. POOL FLOOR AND WALLS, (SHOTCRETE), 4,500 PSI @ 28 DAYS, #4 REBARS @ 8" O.C.E.W., TYP.

**1 LONGITUDINAL SECTION**  
SCALE: 3/8" = 1'-0"

INSTALL 6"± SELF-COMPACTING, GRAVEL FILL UNDER POOL

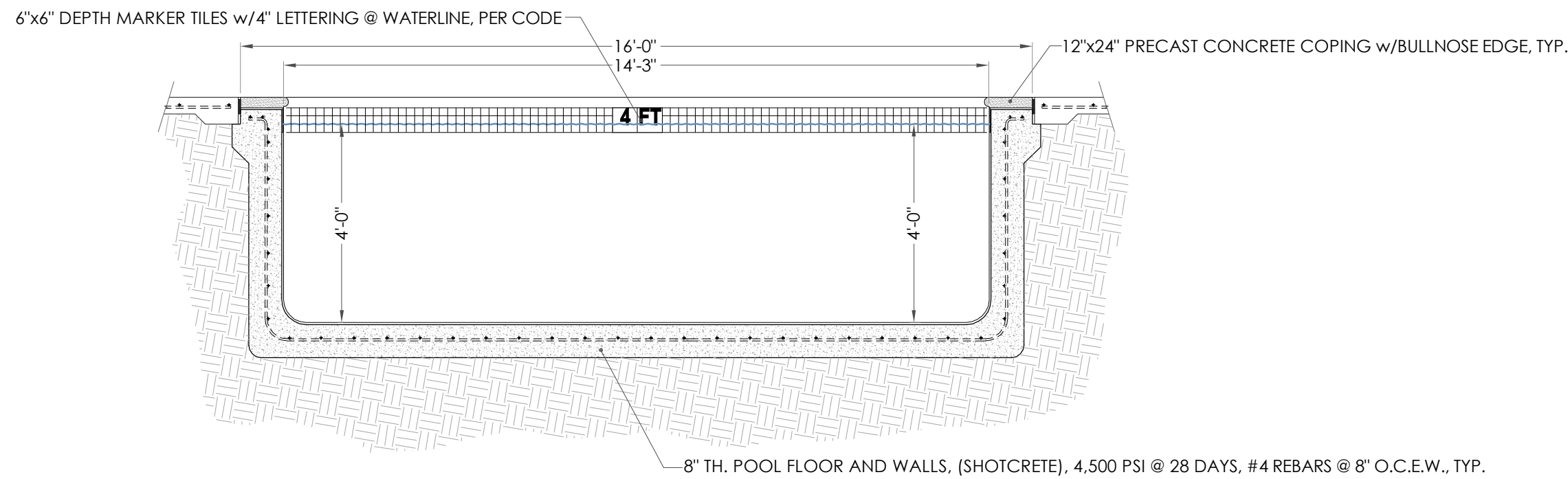

**2 LATERAL SECTION**  
SCALE: 3/8" = 1'-0"

INSTALL 6"± SELF-COMPACTING, GRAVEL FILL UNDER POOL

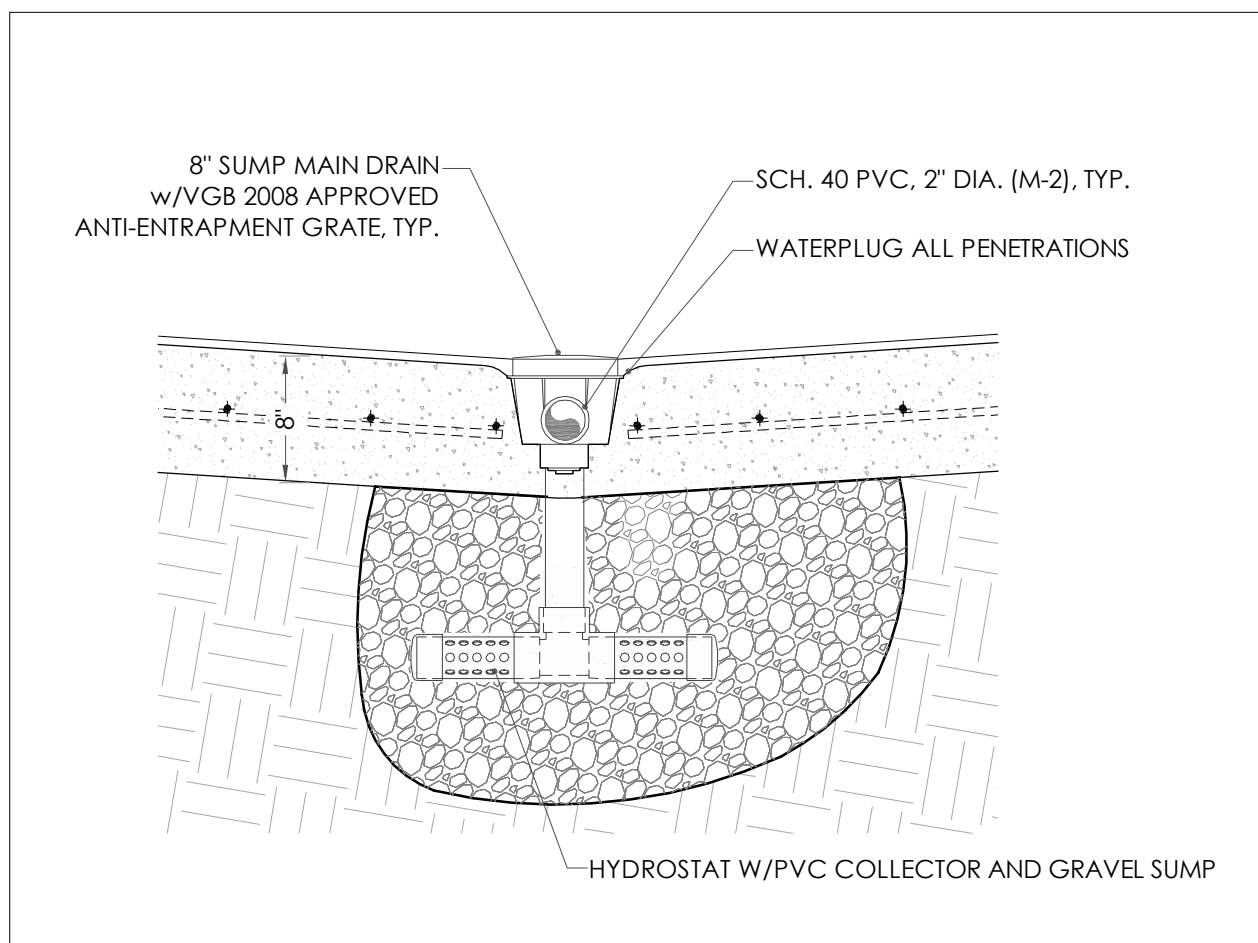

**7 MAIN DRAIN SECTION**  
SCALE: 1" = 1'-0"

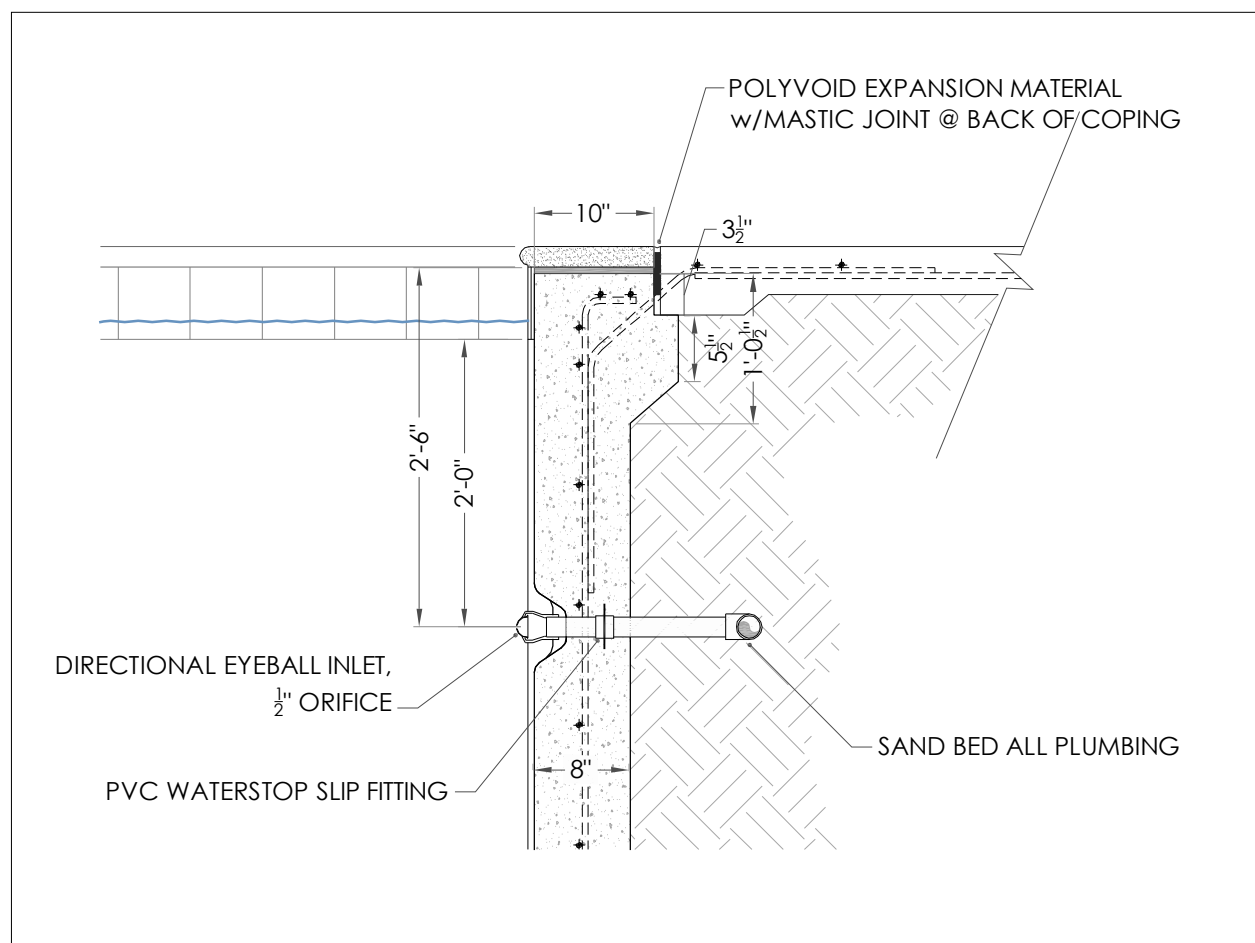

**6 WALL RETURN**  
SCALE: 3/4" = 1'-0"

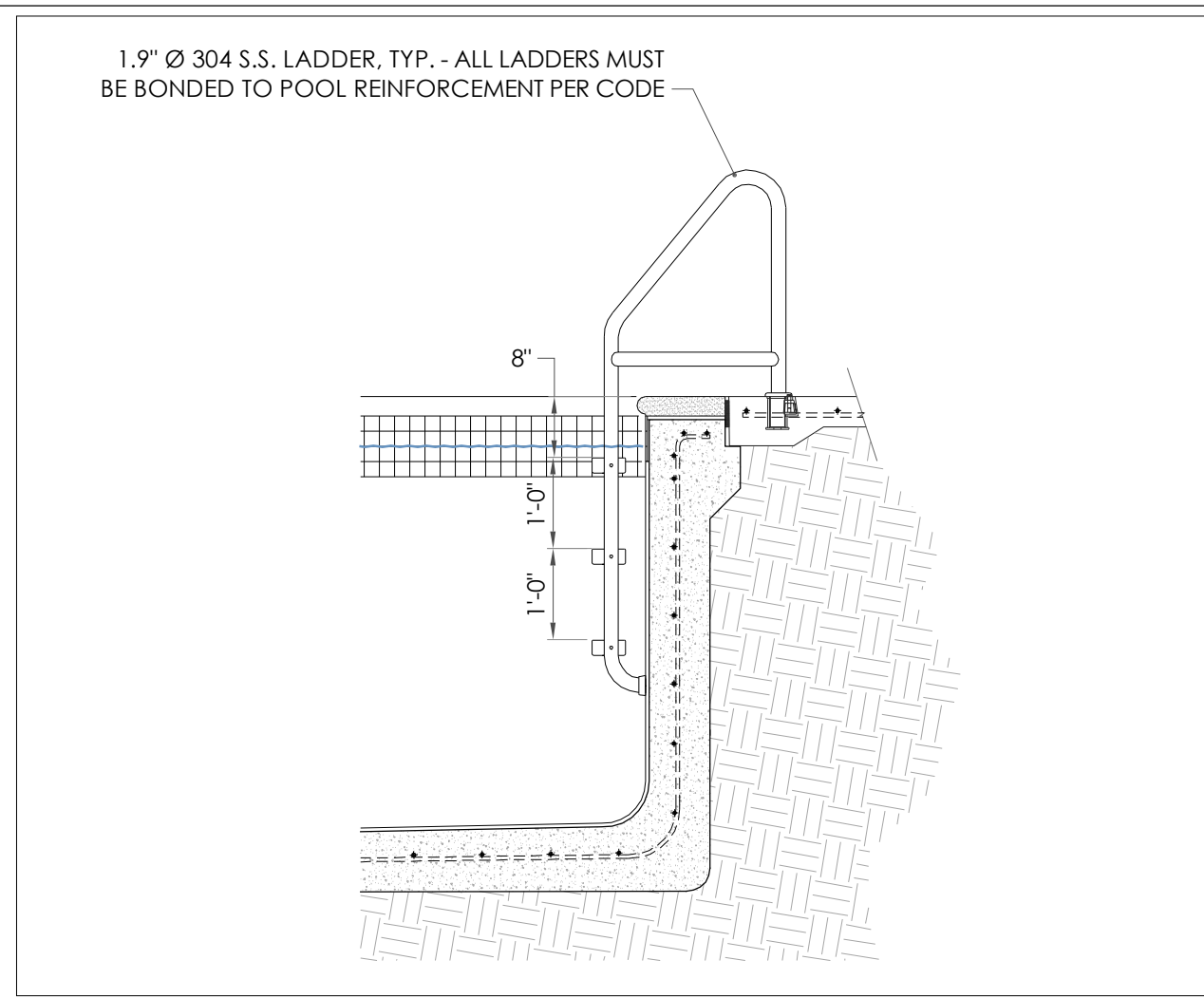

**3 LADDER DETAIL**  
SCALE: 1/2" = 1'-0"

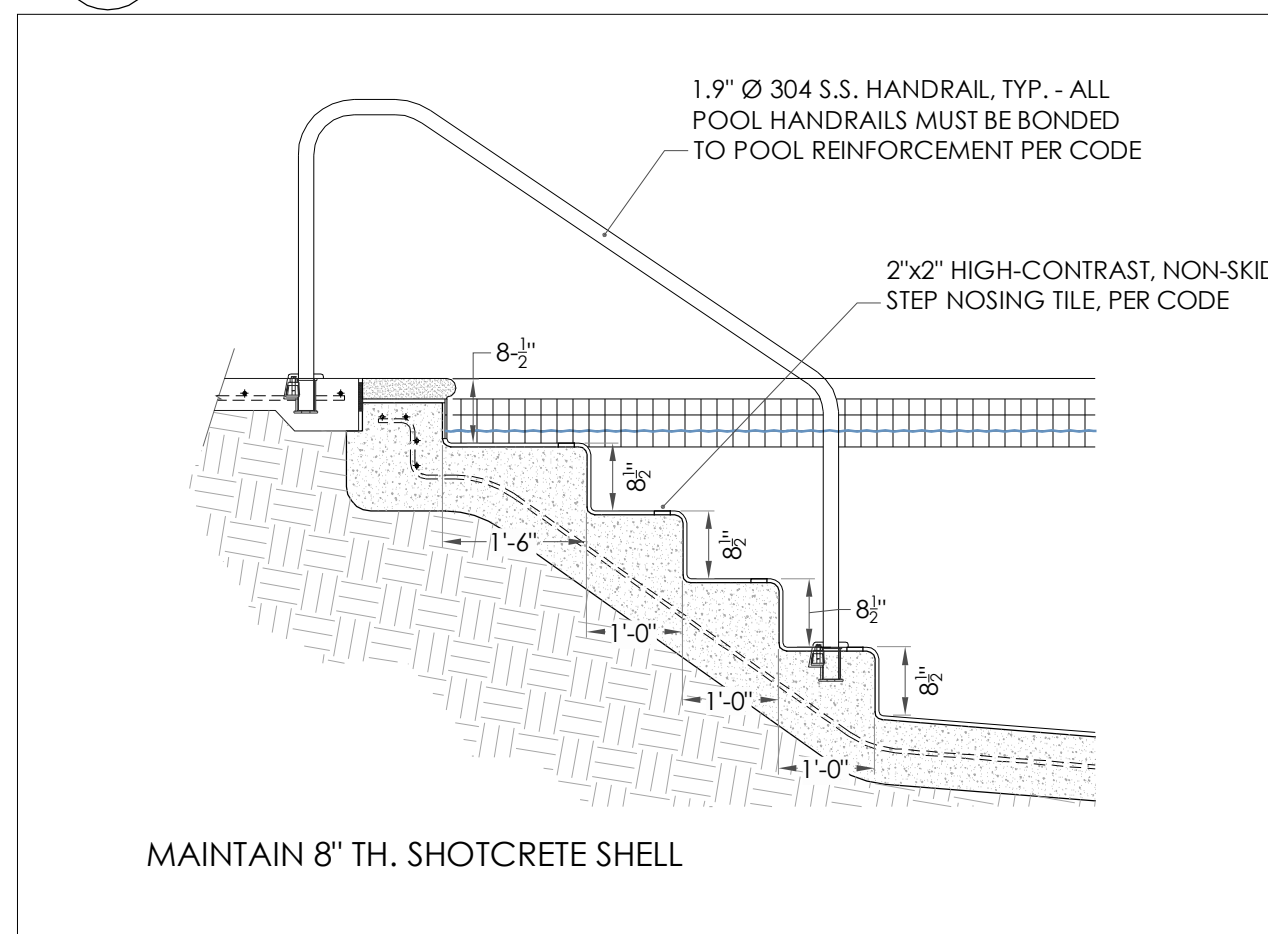

**4 STEPS SECTION**  
SCALE: 1/2" = 1'-0"

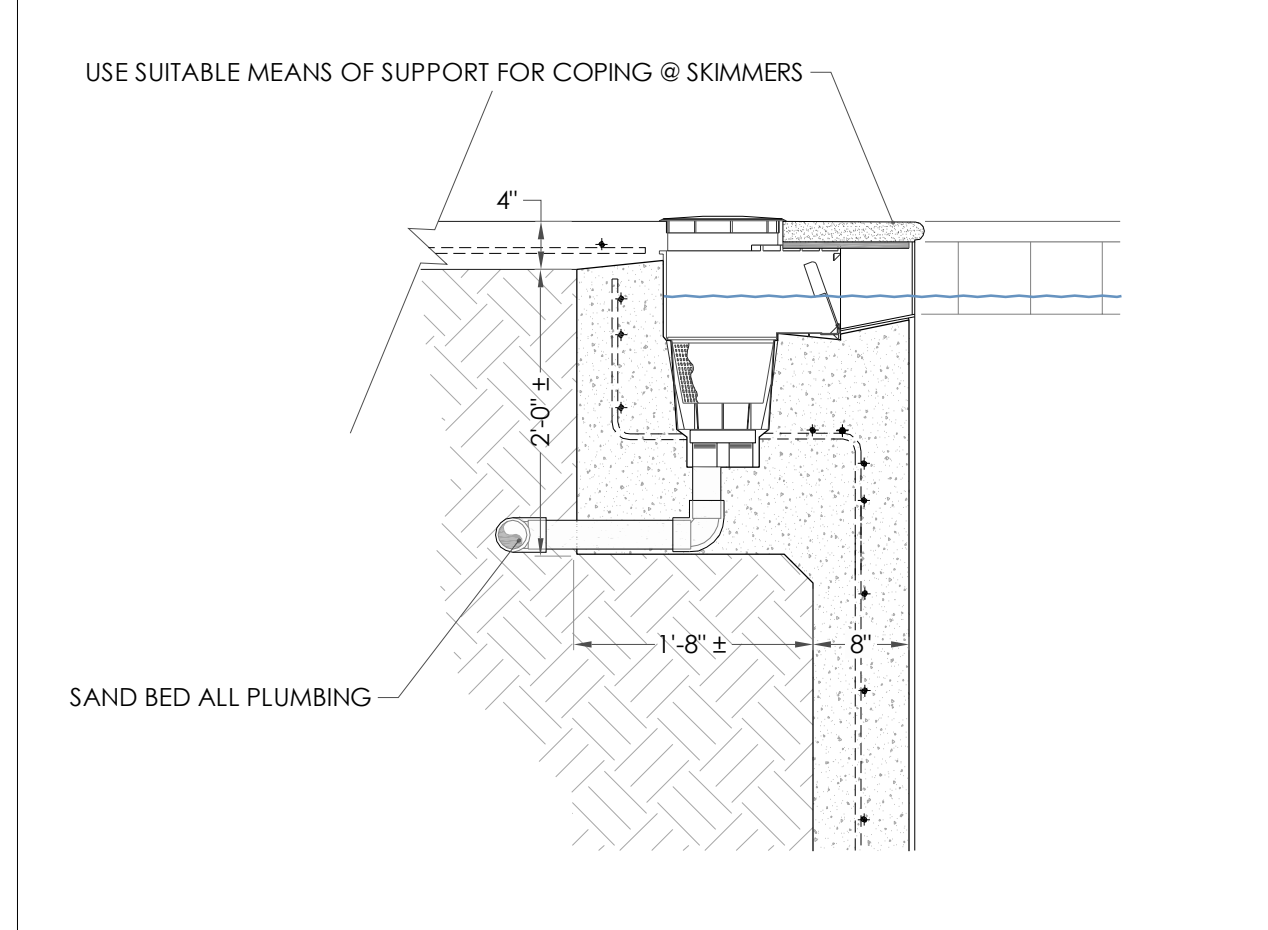

**5 SKIMMER SECTION**  
SCALE: 3/4" = 1'-0"

THIS DRAWING, ALL INFORMATION CONTAINED WITHIN, AND ALL SUBMITTED INFORMATION RELATING TO THIS DRAWING, IS THE PROPERTY OF REYNA DESIGN. POSSESSION, USE, OR DUPLICATION BY ANYONE OTHER THAN THE INTENDED RECIPIENT(S), OR WITHOUT EXPLICIT AUTHORIZATION IS PROHIBITED BY LAW AND SUBJECT TO PROSECUTION.



**POOL EQUIPMENT**

NO.	DESCRIPTION		
P1	PENTAIR WHISPERFLO	FILTRATION PUMP	120v, 1-PHASE, 1HP, 6 AMPS
F1	PENTAIR CLEAN AND CLEAR PLUS	CARTRIDGE FILTER	240 SQ FT.
C1	PENTAIR RAINBOW HC3315	CHLORINATOR	TRI-CHLOR TABLET FEEDER
H1	PENTAIR MASTERTEMP 125	POOL HEATER	125 BTU, 3/4" NG
FIG	FILTER INFLUENT PRESSURE GAUGE	(PROVIDED WITH FILTER)	
FEG	FILTER EFFLUENT PRESSURE GAUGE	SEE SPECS	
FM	(FLOW METER) B&W	BLUE WHITE, 2" VERTICAL MOUNT	
VG	(VACUUM GAUGE)	SEE SPECS	
PL	(POOL ELEC. PANEL)	DISCONNECT PANEL FOR POOL EQUIPMENT, NEMA 4 MIN.	
TC	INTERMATIC T103R	TIME CLOCK FOR POOL LIGHTS	
RPZ	RPZ BACKFLOW PREVENTOR	BACKFLOW PREVENTOR PER CODE	

**NOTES:**

ALL ELECTRICAL PER NEC-250, 680  
 ALL UNDERGROUND WIRING, REF. NEC-680.10  
 MAINTENANCE DISCONNECTING MEANS, REF. NEC-680.12

POOL MOTORS, REF. NEC-680.21  
 GFCI PROTECTION, REF. NEC-680.21(C) AND 680.22(A)(4)

JUNCTION BOXES AND ELECTRICAL ENCLOSURES FOR TRANSFORMERS OR GFCI'S, REF. NEC-680.24  
 EQUIPOTENTIAL BONDING, REF. NEC-680.26, SEE SHEET SP-1.2 FOR POOL PERIMETER BONDING LAYOUT/DIAGRAM

HEATER VENTILATION BY OTHERS - MECHANICAL CONTRACTOR TO SUPPLY VENT TO OUTSIDE AND MAKE-UP AIR LOUVER(S) AS REQUIRED. REFER TO HEATER MANUFACTURER SPECIFICATIONS FOR REQUIREMENTS.

NATURAL GAS SUPPLY LINE TO HEATER SHALL BE INSTALLED BY LICENSED PLUMBER ONLY. VERIFY ALL CODES PER LOCAL JURISDICTION AND/OR THE LATEST EDITION OF THE NATIONAL FUEL GAS CODE, ANSI Z223.1/NFPA54 AND THE NATIONAL ELECTRICAL CODE, ANSI/NFPA70 (U.S.), OR STANDARDS CSA B149 - INSTALLATION CODES FOR GAS-BURNING APPLIANCES AND EQUIPMENT.

THE HEATER, WHEN INSTALLED, MUST BE ELECTRICALLY GROUNDED AND BONDED IN ACCORDANCE WITH LOCAL CODES, OR, IN ABSENCE OF LOCAL CODES, WITH THE NATIONAL ELECTRICAL CODE, ANSI/NFPA70, AS APPLICABLE

HEATER REQUIRES 120V EXTERNAL POWER SOURCE

NO MORE THAN 25 LBS OF CHLORINE TABS OR 4 GALLONS OF MURATIC ACID SHALL BE STORED ON SITE AT ANY TIME, PER CODE.

BARE COPPER GROUND BOND TO CONNECT POOL PUMP TO COMMON GROUND AND CONTINUE TO POOL REINFORCEMENT STEEL, PER CODE.

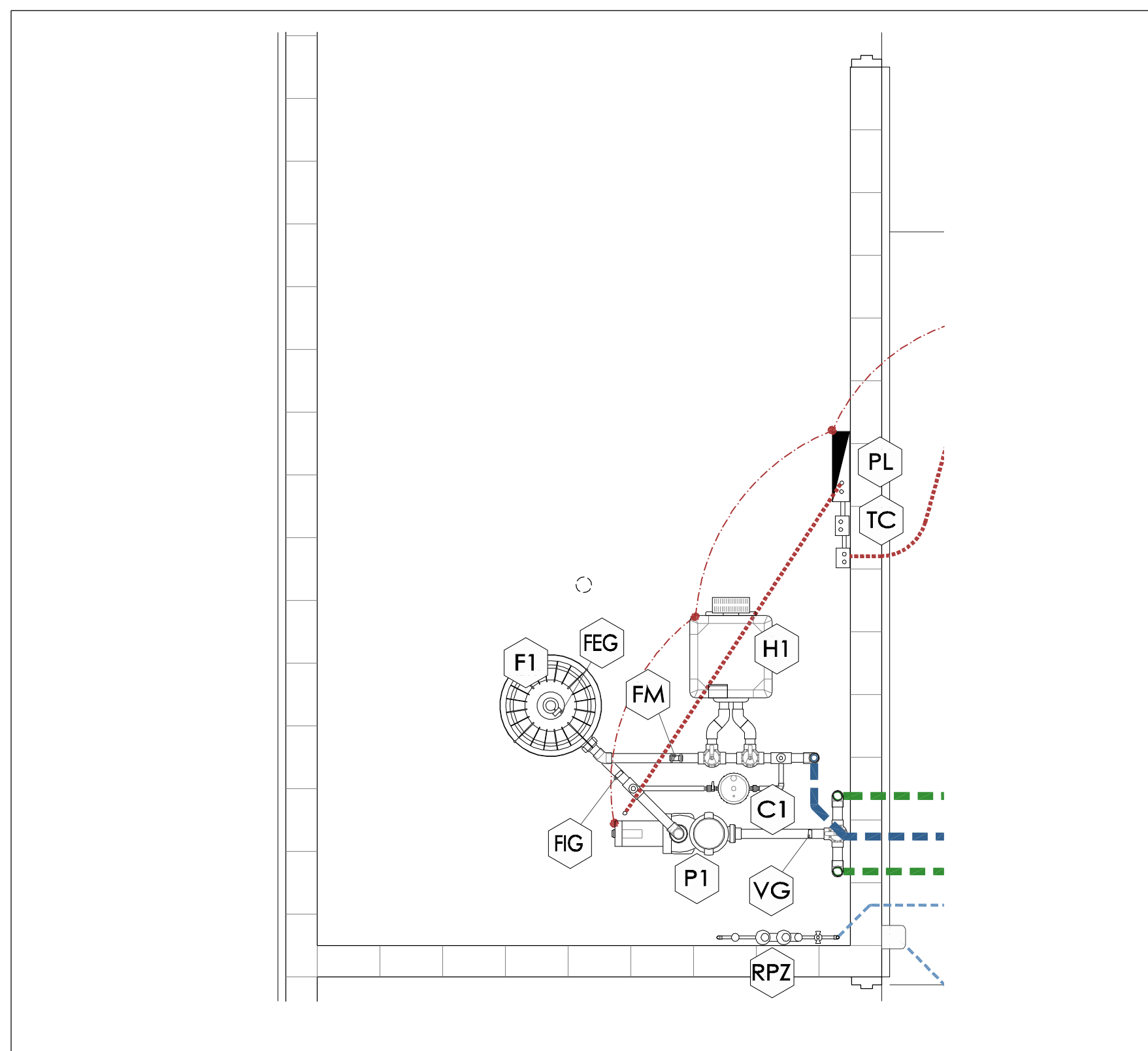

**EQUIPMENT ROOM LAYOUT**

SCALE: 3/8" = 1' - 0"

- ALL DIMENSIONS AND EQUIPMENT LOCATIONS ARE TO BE FIELD VERIFIED AND ARE SUBJECT TO CHANGE AT THE DISCRETION OF OWNER AND/OR CONTRACTOR

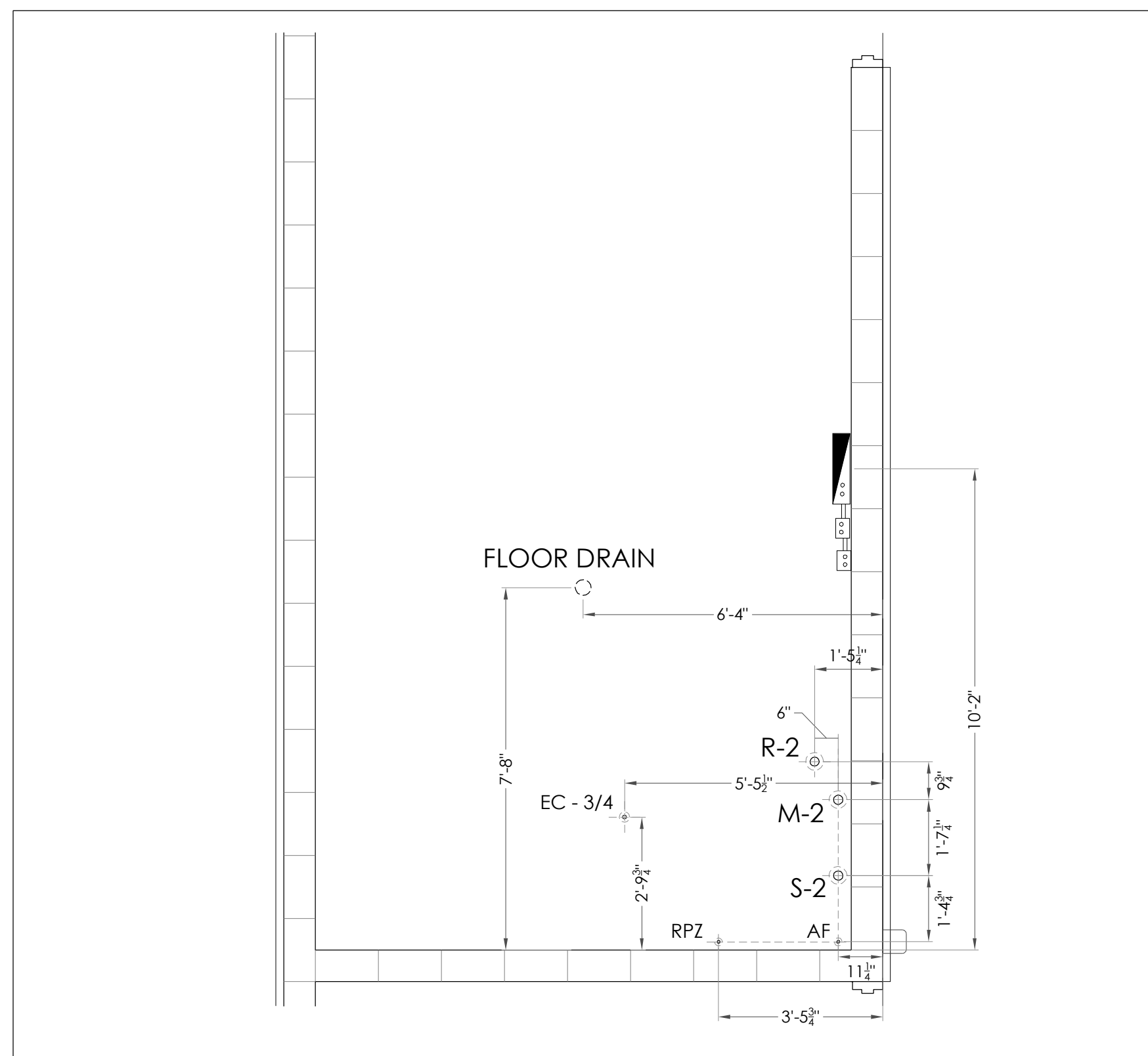

**EQUIPMENT ROOM STUB-OUTS**

SCALE: 3/8" = 1' - 0"